

United States Department of the Interior
National Park ServiceNational Register of Historic Places
Inventory—Nomination FormSee instructions in *How to Complete National Register Forms*
Type all entries—complete applicable sections

For NPS use only

received

date entered

1. Name

historic Hamilton Township Schoolhouse No. 4

and/or common Brady House

2. Location

street & number State Road 67, just south of Co. Rd. 450 North N/A not for publication

city, town Muncie ☒ vicinity of

state Indiana code 018 county Delaware code 035

3. Classification

Category	Ownership	Status	Present Use
<input type="checkbox"/> district	<input type="checkbox"/> public	<input checked="" type="checkbox"/> occupied	<input type="checkbox"/> agriculture
<input checked="" type="checkbox"/> building(s)	<input checked="" type="checkbox"/> private	<input type="checkbox"/> unoccupied	<input type="checkbox"/> commercial
<input type="checkbox"/> structure	<input type="checkbox"/> both	<input type="checkbox"/> work in progress	<input type="checkbox"/> educational
<input type="checkbox"/> site	Public Acquisition	Accessible	<input checked="" type="checkbox"/> private residence
<input type="checkbox"/> object	<input type="checkbox"/> in process	<input checked="" type="checkbox"/> yes: restricted	<input type="checkbox"/> religious
	<input type="checkbox"/> being considered	<input type="checkbox"/> yes: unrestricted	<input type="checkbox"/> scientific
	N/A	<input type="checkbox"/> no	<input type="checkbox"/> transportation
			<input type="checkbox"/> other:

4. Owner of Property

name David and Kathryn Brady

street & number R. 13, Box 328

city, town Muncie ☒ vicinity of state Indiana

5. Location of Legal Description

courthouse, registry of deeds, etc. Delaware County Recorder's Office

street & number Delaware County Courthouse, 100 W. Main St.

city, town Muncie state Indiana

6. Representation in Existing Surveys

title N/A has this property been determined eligible? ☐ yes ☒ nodate ☐ federal ☐ state ☐ county ☐ local

depository for survey records N/A

city, town state

7. Description

Condition

☐ excellent

☐ good

☒ fair

☐ deteriorated

☐ ruins

☐ unexposed

Check one

☐ unaltered

☒ altered

Check one

☒ original site

☐ moved date _____

Describe the present and original (if known) physical appearance

The schoolhouse is one and one-half stories, three bays, with a medium gable asphalt shingle roof. It is common bond brick on a raised stone foundation. The main entrance is in a square gabled belltower. This entrance door, on the west facade, is in a plain reveal with a one-light, round-arched, recessed transom and a four course, round-arched voussoir. Above the entrance is a rectangular stone with the inscription, "Built in 1897." Windows on the main floor of the original brick section of the building are four-over-four lights with segmentally-arched or flat heads and stone sills. Double, two-course, brick belt-courses highlight the west facade and belltower. The schoolhouse has two brick chimneys, one center (original) and one offset, and one large gabled dormer on the south side.

The schoolhouse has been "modernized." Most exterior alterations were completed by Norman Richards, a previous resident, between 1917 and 1919. Alterations include a one and one-half story, gabled, shiplap-sided addition on the rear and a connecting enclosed porch (Photo 4). Also, the upstairs attic was finished and a large, gabled dormer added on the south side of the schoolhouse. Other exterior changes include alteration of the west facade half-story windows, now rectangular with four-over-one lights and round arches bricked in, as well as bricking in of the north belltower louvered opening. Two segmentally-arched windows and one door on the east facade were altered when the rear addition was completed. Finally, the exterior was painted in 1919, later whitewashed, and again painted after 1978.

The interior of the original portion of the schoolhouse had three main rooms, and a bath, located just beneath the staircase, which probably originally served as a coatroom. There have been many interior alterations, including addition of a brick fireplace and interior paneling. Most existing trim, though plain and painted, is original. Interior fixtures from Sears, Roebuck and Company were added in 1919 by Mr. Richards.

8. Significance

Period	Areas of Significance—Check and justify below			
<input type="checkbox"/> prehistoric	<input type="checkbox"/> archeology-prehistoric	<input type="checkbox"/> community planning	<input type="checkbox"/> landscape architecture	<input type="checkbox"/> religion
<input type="checkbox"/> 1400-1499	<input type="checkbox"/> archeology-historic	<input type="checkbox"/> conservation	<input type="checkbox"/> law	<input type="checkbox"/> science
<input type="checkbox"/> 1500-1599	<input type="checkbox"/> agriculture	<input type="checkbox"/> economics	<input type="checkbox"/> literature	<input type="checkbox"/> sculpture
<input type="checkbox"/> 1600-1699	<input checked="" type="checkbox"/> architecture	<input type="checkbox"/> education	<input type="checkbox"/> military	<input type="checkbox"/> social
<input type="checkbox"/> 1700-1799	<input type="checkbox"/> art	<input type="checkbox"/> engineering	<input type="checkbox"/> music	<input type="checkbox"/> humanitarian
<input checked="" type="checkbox"/> 1800-1899	<input type="checkbox"/> commerce	<input type="checkbox"/> exploration/settlement	<input type="checkbox"/> philosophy	<input type="checkbox"/> theater
<input type="checkbox"/> 1900-	<input type="checkbox"/> communications	<input type="checkbox"/> industry	<input type="checkbox"/> politics government	<input type="checkbox"/> transportation
		<input type="checkbox"/> invention		<input type="checkbox"/> other (specify)

Specific dates	1897	Builder Architect	Unknown
-----------------------	------	--------------------------	---------

Statement of Significance (in one paragraph)

Hamilton Township Schoolhouse Number 4 has both architectural and historical significance. It is significant as an example of late 19th century rural school architecture, as well as a representative of the district school system of this period in Indiana. Schoolhouse Number 4 is the single remaining district schoolhouse in Hamilton Township.

Built in 1897, Hamilton Township Schoolhouse Number 4 served east-central Hamilton Township. Although built by the Hamilton Township School Board, Schoolhouse Number 4 is not included in the list of commissioned district schoolhouses built in 1897 and 1898, which appears in the Nineteenth Biennial Report of the State Superintendent of Public Instruction. It was probably built by area residents according to a standard plan used for many schoolhouses in the area. During this period, there was much concern regarding proper lighting, ventilation, and heating of school buildings. The plan for Schoolhouse Number 4 is very similar to a plan for a model district schoolhouse which appears in Thomas Helm's History of Delaware County. This plan calls for three rooms, the large, main classroom and two small anterooms, and has specifications for doors, windows, heating, and ventilation. Hamilton Township Schoolhouse Number 4 is significant as an example of rural school architecture in Indiana in the late 19th century.

Schoolhouse Number 4 is associated with the Indiana district school system of the late 19th century. A state law passed in 1851 established the concept of tax-supported free schools in Indiana. Under the new law, schools received financial support from the state, and were available to a much larger proportion of the state's population. Located primarily in rural areas, district schools in Indiana consisted of the traditional one-room school, and included grades one through eight.

In 1899, the consolidation of school districts in Delaware County resulted in the abandonment of Schoolhouse Number 4, only two years after its opening. Its dozen students were transferred to School Number 8 in Royerton. The school was soon converted to residential use, which continues today.

9. Major Bibliographical References

Please see continuation sheet

10. Geographical Data

Acreage of nominated property 0.56 acre

Quadrangle name Eaton

Quadrangle scale 1:24000

UTM References

A

1	6
---	---

6	4	1	1	1	0
---	---	---	---	---	---

4	4	5	7	1	5	0
---	---	---	---	---	---	---

Zone Easting Northing

B

--	--

--	--	--	--

--	--	--	--	--	--

Zone Easting Northing

C

--	--

--	--	--	--

--	--	--	--	--	--

D

--	--

--	--	--	--

--	--	--	--	--	--

E

--	--

--	--	--	--

--	--	--	--	--	--

F

--	--

--	--	--	--

--	--	--	--	--	--

G

--	--

--	--	--	--

--	--	--	--	--	--

H

--	--

--	--	--	--

--	--	--	--	--	--

Verbal boundary description and justification

Please see continuation sheet

List all states and counties for properties overlapping state or county boundaries

state N/A code county code

state code county code

11. Form Prepared By

name/title Lisboth Henning, Graduate Assistant

organization Ball State University

date 10-12-81

street & number 781 Middle Drive Woodruff Place

telephone 632-8251

city or town Indianapolis

state Indiana 46201

12. State Historic Preservation Officer Certification

The evaluated significance of this property within the state is:

☐ national ☐ state ☒ local

As the designated State Historic Preservation Officer for the National Historic Preservation Act of 1966 (Public Law 89-665), I hereby nominate this property for inclusion in the National Register and certify that it has been evaluated according to the criteria and procedures set forth by the National Park Service.

State Historic Preservation Officer signature

title Indiana State Historic Preservation Officer

date 11-7-84

For NPS use only

I hereby certify that this property is included in the National Register

date

Keeper of the National Register

Attest:

date

Chief of Registration

United States Department of the Interior
National Park Service

National Register of Historic Places
Inventory—Nomination Form

For NPS use only

received

date entered

Continuation sheet Hamilton Township
Schoolhouse No. 4

Item number 9 and 10

Page 1

Helm, Thomas B. History of Delaware County, Indiana. Chicago: Kingman Brothers, 1881.

Indiana Department of Public Instruction, 19th Biennial Report of the State Superintendent of Public Instruction. Indianapolis: Burford, 1899.

Indiana Department of Public Instruction, 20th Biennial Report of the State Superintendent of Public Instruction. Indianapolis: Burford, 1901.

Indiana Department of Public Instruction, 21st Biennial Report of the State Superintendent of Public Instruction. Indianapolis: Burford, 1903.

Kemper, William H., ed. A Twentieth-Century History of Delaware County, Indiana. Chicago: Lewis, 1908.

Item number 10

Commencing at NW corner of E $\frac{1}{2}$ of SW $\frac{1}{4}$, Section 24, Township 21N, Range 10E and running East along the North line of said East 1/2, Southwest 1/4 a distance of 1,028.8 feet to the centerline of State Road 67; turn angle to right, 126 degrees 56 feet and measure Southwest along said centerline a distance of 176.8 feet to point of beginning, and continuing thence Southwest along the centerline of State Road 67 159.05 feet; thence East along the property line fence and parallel with North line of East 1/2, Southwest 1/4 a distance of 258.5 feet; thence turn angle to left 79 degrees and measure Northwest 162.2 feet to place of beginning, excluding, however, the present right-of-way of State Road 67.

Hamilton Twp. Schoolhouse No. 4
vic. of Muncie, Indiana
UTM Reference: 16/641110/4457150

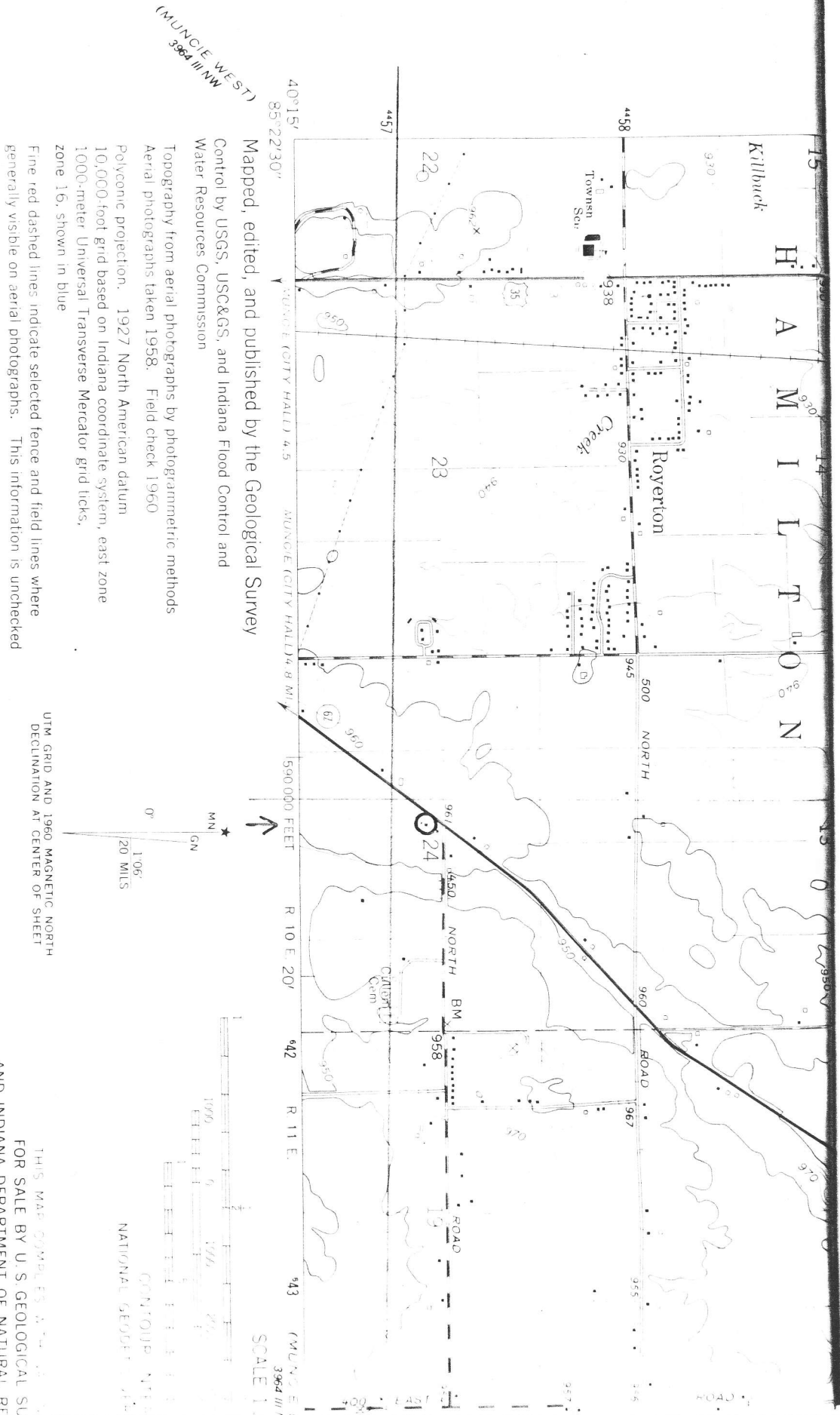

THIS MAP COMPLETES A SERIES OF
FOR SALE BY U.S. GEOLOGICAL SURVEY
AND INDIANA DEPARTMENT OF NATURAL RESOURCES
A FOLDER DESCRIBING TOPOGRAPHIC MAPS A