

United States Department of the Interior
National Park Service

FINAL

National Register of Historic Places Registration Form

This form is for use in nominating or requesting determinations for individual properties and districts. See instructions in *How to Complete the National Register of Historic Places Registration Form* (National Register Bulletin 16A). Complete each item by marking "x" in the appropriate box or by entering the information requested. If an item does not apply to the property being documented, enter "N/A" for "not applicable." For functions, architectural classification, materials, and areas of significance, enter only categories and subcategories from the instructions. Place additional entries and narrative items on continuation sheets (NPS Form 10-900a). Use a typewriter, word processor, or computer, to complete all items.

1. Name of Property

historic name York, W.H., Round Barn

other names/site number Thompson Barn

2. Location

street & number C.R. 249, 1/2 mile south of Lodi N/A not for publication

city or town Lodi vicinity

state Indiana code IN county Parke code 121 zip code 47928

3. State/Federal Agency Certification

As the designated authority under the National Historic Preservation Act, as amended, I hereby certify that this nomination request for determination of eligibility meets the documentation standards for registering properties in the National Register of Historic Places and meets the procedural and professional requirements set forth in 36 CFR Part 60. In my opinion, the property meets does not meet the National Register criteria. I recommend that this property be considered significant nationally statewide locally. (See continuation sheet for additional comments.)

Patrick R. Kelsner

8-5-93

Signature of certifying official/Title

Date

Indiana Department of Natural Resources

State of Federal agency and bureau

In my opinion, the property meets does not meet the National Register criteria. (See continuation sheet for additional comments.)

Signature of certifying official/Title

Date

State or Federal agency and bureau

4. National Park Service Certification

I hereby certify that the property is:

Signature of the Keeper

Date of Action

- entered in the National Register.
 See continuation sheet.
- determined eligible for the National Register
 See continuation sheet.
- determined not eligible for the National Register.
- removed from the National Register.
- other, (explain:)

York Round Barn
Name of Property

Parke Co., IN
County and State

5. Classification

Ownership of Property
(Check as many boxes as apply)

- private
- public-local
- public-State
- public-Federal

Category of Property
(Check only one box)

- building(s)
- district
- site
- structure
- object

Number of Resources within Property
(Do not include previously listed resources in the count.)

Contributing	Noncontributing	
1	0	buildings
0	0	sites
0	0	structures
0	0	objects
1	0	Total

Name of related multiple property listing
(Enter "N/A" if property is not part of a multiple property listing.)

Round and Polygonal Barns of Indiana

Number of contributing resources previously listed in the National Register

0

6. Function or Use

Historic Functions
(Enter categories from instructions)

AGRICULTURE: animal facility

Current Functions
(Enter categories from instructions)

AGRICULTURE: storage

7. Description

Architectural Classification
(Enter categories from instructions)

OTHER: true-circular barn

Materials
(Enter categories from instructions)

foundation BRICK

walls WOOD: weatherboard

WOOD: shingle

roof WOOD: shingle

other

Narrative Description

(Describe the historic and current condition of the property on one or more continuation sheets.)

York Round Barn
Name of Property

Parke Co., IN
County and State

8. Statement of Significance

Applicable National Register Criteria

(Mark "x" in one or more boxes for the criteria qualifying the property for National Register listing.)

- A** Property is associated with events that have made a significant contribution to the broad patterns of our history.
- B** Property is associated with the lives of persons significant in our past.
- C** Property embodies the distinctive characteristics of a type, period, or method of construction or represents the work of a master, or possesses high artistic values, or represents a significant and distinguishable entity whose components lack individual distinction.
- D** Property has yielded, or is likely to yield, information important in prehistory or history.

Criteria Considerations

(Mark "x" in all the boxes that apply.)

Property is:

- A** owned by a religious institution or used for religious purposes.
- B** removed from its original location.
- C** a birthplace or grave.
- D** a cemetery.
- E** a reconstructed building, object, or structure.
- F** a commemorative property.
- G** less than 50 years of age or achieved significance within the past 50 years.

Narrative Statement of Significance

(Explain the significance of the property on one or more continuation sheets.)

9. Major Bibliographical References

Bibliography

(Cite the books, articles, and other sources used in preparing this form on one or more continuation sheets.)

Previous documentation on file (NPS):

- preliminary determination of individual listing (36 CFR 67) has been requested
- previously listed in the National Register
- previously determined eligible by the National Register
- designated a National Historic Landmark
- recorded by Historic American Buildings Survey # _____
- recorded by Historic American Engineering Record # _____

Areas of Significance

(Enter categories from instructions)

AGRICULTURE

ARCHITECTURE

Period of Significance

c. 1895-1936

Significant Dates

c. 1895

Significant Person

(Complete if Criterion B is marked above)

N/A

Cultural Affiliation

N/A

Architect/Builder

Unknown

Primary location of additional data:

- State Historic Preservation Office
- Other State agency
- Federal agency
- Local government
- University
- Other

Name of repository: Historic Landmarks Foundation of Indiana

York Round Barn
Name of Property

Parke Co., IN
County and State

10. Geographical Data

Acreage of Property Less than one acre.

UTM References

(Place additional UTM references on a continuation sheet.)

1

1	6	4	6	6	2	0	0	4	4	2	1	4	4	0
Zone			Easting					Northing						

2

Zone			Easting					Northing						

3

Zone			Easting					Northing						

4

Zone			Easting					Northing						

 See continuation sheet

Verbal Boundary Description

(Describe the boundaries of the property on a continuation sheet.)

Boundary Justification

(Explain why the boundaries were selected on a continuation sheet.)

11. Form Prepared By

name/title Jerry McMahan

organization Historic Landmarks Foundation of Indiana date November 11, 1991

street & number 340 West Michigan Street telephone (317) 639-4534

city or town Indianapolis state IN zip code 46202

Additional Documentation

Submit the following items with the completed form:

Continuation Sheets

Maps

A **USGS map** (7.5 or 15 minute series) indicating the property's location.

A **Sketch map** for historic districts and properties having large acreage or numerous resources.

Photographs

Representative **black and white photographs** of the property.

Additional items

(Check with the SHPO or FPO for any additional items)

Property Owner

(Complete this item at the request of SHPO or FPO.)

name R. F. Thompson

street & number 114 North Division Road, Box 336 telephone _____

city or town Cayuga state IN zip code 47928

Paperwork Reduction Act Statement: This information is being collected for applications to the National Register of Historic Places to nominate properties for listing or determine eligibility for listing, to list properties, and to amend existing listings. Response to this request is required to obtain a benefit in accordance with the National Historic Preservation Act, as amended (16 U.S.C. 470 *et seq.*).

Estimated Burden Statement: Public reporting burden for this form is estimated to average 18.1 hours per response including time for reviewing instructions, gathering and maintaining data, and completing and reviewing the form. Direct comments regarding this burden estimate or any aspect of this form to the Chief, Administrative Services Division, National Park Service, P.O. Box 37127, Washington, DC 20013-7127; and the Office of Management and Budget, Paperwork Reductions Projects (1024-0018), Washington, DC 20503.

United States Department of the Interior
National Park Service

National Register of Historic Places
Continuation Sheet

Section number 7 Page 1

In rural Parke County, just east of Lodi and the Coal Creek Covered Bridge, stands the W.H. York Round Barn. Built in c.1895, the barn rests in a natural depression in pasture land. Adjacent are the remains of the York Farm; a deteriorated farmhouse and two sheds.

The York Round Barn is a wood frame structure with a brick foundation. It is roughly 56 feet in diameter. Exterior walls are covered in wood flush drop siding. Because of the natural slope, the foundation of the west half creates a full one story tall wall, but the east half of the building has only several feet of foundation exposed.

The north or primary elevation of the barn has central double leaf sliding doors (photo 2). Flanking the doors, the north half of this face of the barn has two square window openings on either side. Originally, these windows were likely four-light, single sash units, but several have been boarded over or are missing. Between the two windows to the left of the sliding doors is a regular door which is partly boarded shut.

The east side has a sliding hay door. Left of the door is a window. The south elevation has sliding doors similar to the north side (photo 3). The west elevation is more dramatic, since this side of the building nestles into the natural depression, exposing the brick foundation a full story (photo 4). The foundation has a wide opening for sliding doors at this lower grade, as well as two window openings (minus sash) flanking the doorway. The wood sided walls of this face have a hay door centered over the lower sliding doorway, and two window openings.

Above the wood walls, which rise the equivalent of two stories (yet contain only one level) is the conical roof sheathed in old (possibly original) wood shingles. Centered on the apex of the roof is a circular cupola having seven louvered vents. The cupola has a wood belt course at the sill level of the vents and is clad in imbricated fish scale wood shingles. The cupola itself has a conical roof.

The interior of the York Round Barn has two levels; the lower story occupies only the west half of the barn, while the upper story is open for hay storage. Originally, the lower level had cattle pens partly defined by a half circle of wood posts which provide support for the upper level joists. A corn crib stands centered on the east wall. The upper level features two concentric

**United States Department of the Interior
National Park Service**

**National Register of Historic Places
Continuation Sheet**

Section number 7 Page 2

York Round Barn
Parke County, Indiana

circles of posts which support the conical roof structure (photos 5 and 6). The outer ring of posts rise to support a circular roof purlin about halfway up the roof's slope. The inner circle of posts supports a similar ring at the base of the cupola. In addition, a large post at the very center rises part way to the cupola, then terminates; with diagonal braces reaching to the previously described intermediate purlin ring. Rafters radiate from the cupola to form the rest of the roof structure. The upper level creates a complex space of interweaving timbers, a typical feature of early round barns such as this.

Although somewhat deteriorated, the York Round Barn has good integrity. The barn clearly meets all of the standards for registration set forth in the Multiple Property Documentation Form "Round and Polygonal Barns of Indiana".

United States Department of the Interior
National Park Service

National Register of Historic Places
Continuation Sheet

Section number 7 Page 3

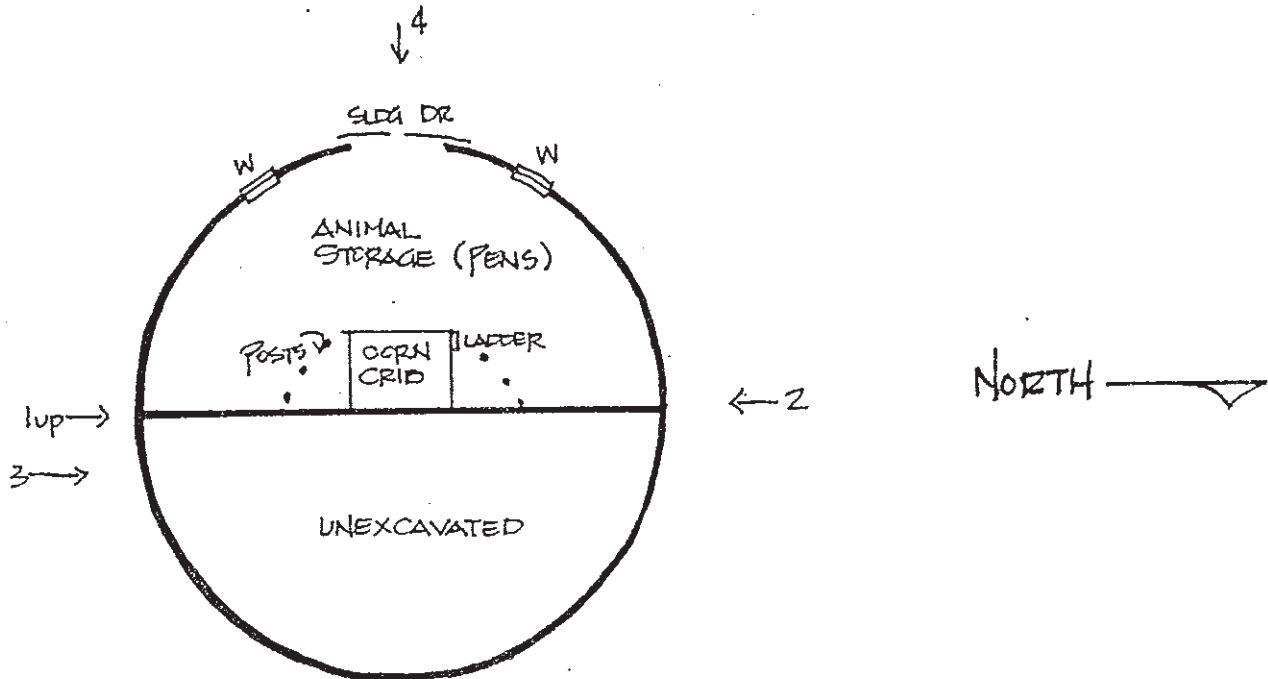

LOWER LEVEL

Note: W=Window

UPPER LEVEL

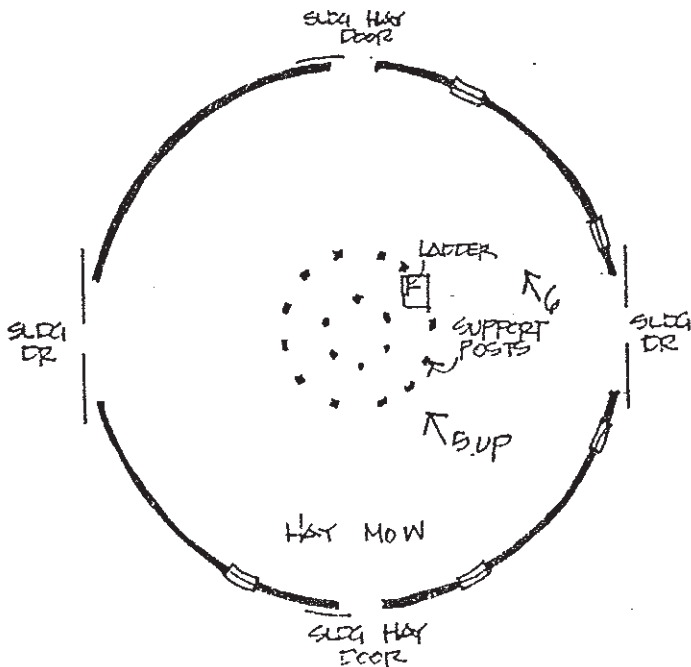

YORK (THOMPSON)

BARN

c. 1895 TRUE CIRCLE
PARKE COUNTY, INDIANA
LIBERTY TOWNSHIP

United States Department of the Interior
National Park Service

National Register of Historic Places
Continuation Sheet

Section number 8 & 9 Page 4

York Round Barn
Parke County, Indiana

The W.H. York Round Barn, c.1895, meets Criteria A and C for its significance in the fields of agriculture and architecture. The first true circular barn built in Indiana, the York Barn is significant within the context established in the Multiple Property Documentation Form "Round and Polygonal Barns of Indiana". The period of significance of the barn is c.1895 (date of construction) to 1936. After 1936, round and polygonal barns were considered obsolete; the last round barn to be erected in Indiana dates from that year.

The York Barn was the first true circular barn to be erected in Indiana. Earlier central plan barns were octagonal. In the 1880s, Franklin King publicized his efforts at round barn construction. The York Barn shows influence of the early octagonal barns, which called for elaborate internal bracing to support the roof. The exterior form of the York Barn, however, shows the influence of King's work. Two other round barns were erected in Indiana during the 19th century: in 1896 (Henry County, Fall Creek Township) and in 1898 (Madison County, Jackson Township). Both have been demolished, leaving the York Barn as the only 19th century round barn in the state. Round barns became the most popular style of central plan barn in Indiana; about two-thirds of the round and polygonal barns erected in the state were round.

W.H. York was a successful Parke County farmer who had the round barn erected in c.1895. The farmstead consisted of a house and two sheds as well as the barn. The house has long since been abandoned and is deteriorated, leaving the round barn isolated. In the 1960s, R.F. Thompson of nearby Cayuga bought the property. Mr. Thompson uses the barn on a limited basis.

9. BIBLIOGRAPHY

Hanou, John. Research on Indiana's round and polygonal barns from 1986 to the present. Archived at HLF1, 340 West Michigan Street, Indianapolis, Indiana 46202.

Intensive architectural survey of Indiana's round and polygonal barns. Conducted by Jerry McMahan, records at the Indiana Division of Historic Preservation and Archeology.

Soike, Lowell J. Without Right Angles, The Round Barns of Iowa.

United States Department of the Interior
National Park Service

**National Register of Historic Places
Continuation Sheet**

Section number 9 & 10 Page 5

York Round Barn
Parke County, Indiana

Des Moines, Iowa: Iowa Historical Department, 1983.

Thompson, R.F. Owner of the York Round Barn, Cayuga, Indiana.
Interview with Jerry McMahan, 27 October 1991.

10. VERBAL BOUNDARY DESCRIPTION

The York Round Barn is located in the NESE of Section 2, T17N-R9W of Liberty Township, Parke County, Indiana. Referring to the site plan, beginning at a point one foot south of the southwest corner of the southernmost shed on the property, proceed west for 100 feet to point B, thence south 200 feet to point C, then east 200 feet to point D, thence north 200 feet to point E, point E being in line with points A and B, then proceed west 100 feet to point A.

BOUNDARY JUSTIFICATION

The York Barn is the most significant building remaining on the property and has the characteristics needed to convey its significance as a round barn. The boundary, therefore, includes only the barn and its immediate environment. The immediate surroundings of the barn, including ramps to entries and the natural depression, are an essential part of the design of the barn and are included in the boundary.

United States Department of the Interior
National Park Service

National Register of Historic Places
Continuation Sheet

Section number 10 Page 6

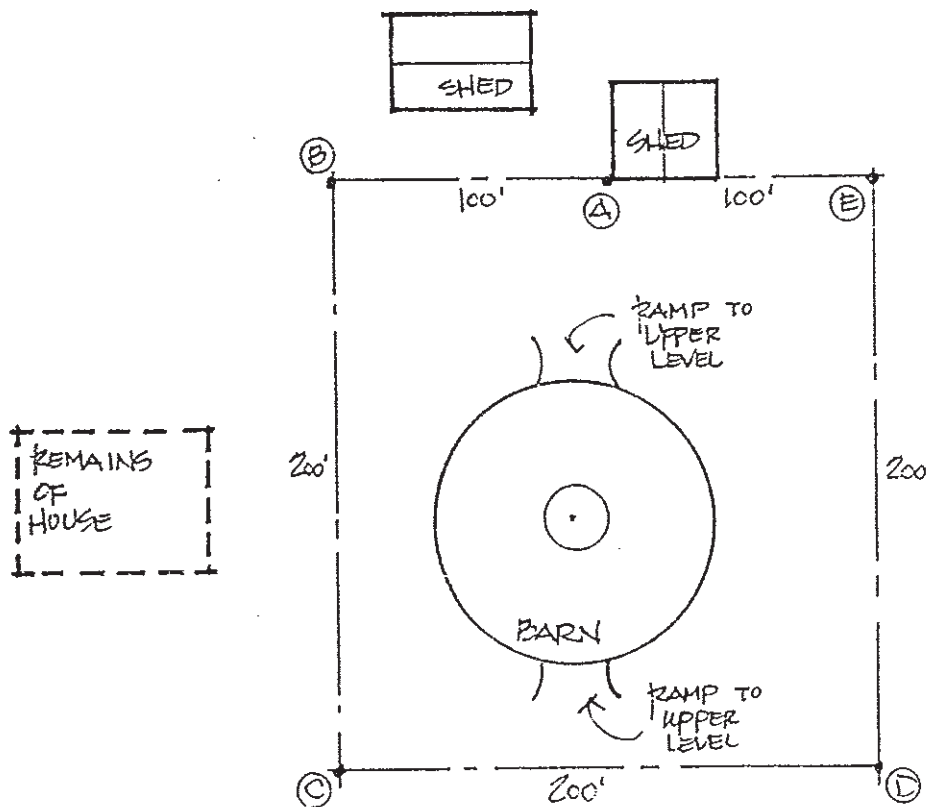
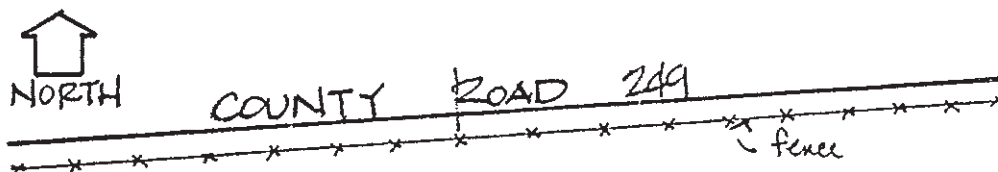

YORK (THOMPSON) BARN

SITE PLAN
NO SCALE

c. 1895 TRUE CIRCLE
PARKE COUNTY, INDIANA
LIBERTY TOWNSHIP