

United States Department of the Interior
National Park Service

For NPS use only

National Register of Historic Places
Inventory—Nomination Form

received

date entered

See instructions in *How to Complete National Register Forms*
Type all entries—complete applicable sections

1. Name

historic Harrell, Dr. Samuel, House

and/or common Harrell House

2. Location

street & number 399 N. 10th Street

N/A not for publication

city, town Noblesville N/A vicinity of

state Indiana code 018 county Hamilton code 057

3. Classification

Category	Ownership	Status	Present Use
<input type="checkbox"/> district	<input type="checkbox"/> public	<input checked="" type="checkbox"/> occupied	<input type="checkbox"/> agriculture
<input checked="" type="checkbox"/> building(s)	<input checked="" type="checkbox"/> private	<input type="checkbox"/> unoccupied	<input type="checkbox"/> commercial
<input type="checkbox"/> structure	<input type="checkbox"/> both	<input type="checkbox"/> work in progress	<input type="checkbox"/> educational
<input type="checkbox"/> site	Public Acquisition	Accessible	<input checked="" type="checkbox"/> private residence
<input type="checkbox"/> object	<input type="checkbox"/> in process	<input checked="" type="checkbox"/> yes: restricted	<input type="checkbox"/> religious
	<input type="checkbox"/> being considered	<input type="checkbox"/> yes: unrestricted	<input type="checkbox"/> scientific
	N/A	<input type="checkbox"/> no	<input type="checkbox"/> transportation
			<input type="checkbox"/> other:

4. Owner of Property

name Mr. and Mrs. George C. Elliott

street & number 399 N. 10th Street

city, town Noblesville N/A vicinity of state Indiana 46060

5. Location of Legal Description

courthouse, registry of deeds, etc. Hamilton County Courthouse

street & number Public Square

city, town Noblesville state Indiana 46060

6. Representation in Existing Surveys

title Indiana Historic Sites and Structures Inventory has this property been determined eligible? yes no

date 1978 federal state county local

depository for survey records Indiana Department of Natural Resources

city, town Indianapolis state Indiana

7. Description

Condition

excellent
 good
 fair

deteriorated
 ruins
 unexposed

Check one

unaltered
 altered

Check one

original site
 moved

date N/A

Describe the present and original (if known) physical appearance

The Harrell House is situated on a prominent corner on the main north-south residential street in Noblesville. Queen Anne in style, the house is a two-and-one-half story, detached building with irregular plan and massing and a multi-gable/hip roof. There is a three-story polygonal tower at the northeast corner. The house is of wood frame construction.

The front porch extends across the main (east) facade, wraps around the tower, and extends on the north side of the house. The classical revival porch is composed of columns, a molded, box cornice, brackets under extended eaves, and a shed roof. There are pedimented gables crossing the roof above each of the two sets of steps, one each on the east and north sides, that lead up to the porch. On the south side of the house is a hip-roof porte-cochere and a second-story, gable-roof porch (photo #6). These exhibit the same type of ornamentation as the front porch.

Windows are variously shaped, sized and detailed. Most of the windows are double-hung. Most of those on the upper stories of the main facade have a multi-lighted upper sash and one light in the lower sash. Many of the windows are arranged in groups. There are paired, stained-glass windows in each of three pedimented, attic gables, which are on the east, north, and south sides of the house. On the east and south sides of the roof are gable-roof dormers with paired, double-hung windows.

Entrances include the double-leaf main entrance, with spindled screen doors (photo #12), and the porte-cochere entrance on the south side, which has a stained glass window with the words, "S. Harrell M.D." (Photo #9).

The house has a molded, box cornice and brackets under the extended eaves. The roof is covered with slates, both fishcale and flat-edged. Along the ridges of the roof is cast-iron cresting. Atop the polygonal tower is a cast-iron finial.

Alterations to the house include a partial porch enclosure in 1931 and a rear entry enclosure for a pantry in 1981. The original siding was covered with aluminum siding of the same dimension in the 1970s.

The house has 7200 square feet of space, plus a small usable basement. The main story, with 11 foot ceilings, has six rooms and two half-baths. The second floor, with 10 foot ceilings, has six bedrooms and two full baths. The third floor is used as a playroom. Four fireplaces are in the house. Ornamentation includes molded plaster ceilings and outstanding carved oak woodwork. Of particular interest is an archway into the family room, with griffins supporting elaborate fretwork, and the ornate front stairs with 4½ foot wide steps.

Also included is the original two story, frame carriage house, which now houses a four-car garage. The second story of the carriage house was converted in the 1930s into an apartment.

8. Significance

Period	Areas of Significance—Check and justify below			
<input type="checkbox"/> prehistoric	<input type="checkbox"/> archeology-prehistoric	<input type="checkbox"/> community planning	<input type="checkbox"/> landscape architecture	<input type="checkbox"/> religion
<input type="checkbox"/> 1400–1499	<input type="checkbox"/> archeology-historic	<input type="checkbox"/> conservation	<input type="checkbox"/> law	<input type="checkbox"/> science
<input type="checkbox"/> 1500–1599	<input type="checkbox"/> agriculture	<input type="checkbox"/> economics	<input type="checkbox"/> literature	<input type="checkbox"/> sculpture
<input type="checkbox"/> 1600–1699	<input checked="" type="checkbox"/> architecture	<input type="checkbox"/> education	<input type="checkbox"/> military	<input type="checkbox"/> social/ humanitarian
<input type="checkbox"/> 1700–1799	<input type="checkbox"/> art	<input type="checkbox"/> engineering	<input type="checkbox"/> music	<input type="checkbox"/> theater
<input checked="" type="checkbox"/> 1800–1899	<input type="checkbox"/> commerce	<input type="checkbox"/> exploration/settlement	<input type="checkbox"/> philosophy	<input type="checkbox"/> transportation
<input type="checkbox"/> 1900–	<input type="checkbox"/> communications	<input type="checkbox"/> industry	<input type="checkbox"/> politics/government	<input checked="" type="checkbox"/> other (specify) Medicine
<input type="checkbox"/> invention				

Specific dates 1898

Builder Architect Unknown

Statement of Significance ~~(in one paragraph)~~

The Harrell House is significant for its architecture, and for its association with Dr. Samuel Harrell, a prominent Noblesville physician. Situated on a prominent corner on the main north-south residential street of Noblesville, the house is probably the most imposing Queen Anne residence in the city.

The house was built for Dr. and Mrs. Samuel Harrell in 1898. Harrell graduated from the University of Michigan Homeopathic Medical school in 1893, and did further study in Vienna and Paris in 1900. He was known for his accurate diagnoses and treatment of difficult cases, and especially skilled in bone and abdominal surgery.

Together with his brother, Dr. Madison Harrell, he established the Harrell Hospital, the first in the County, in 1908. The hospital was sold to Hamilton County in 1915 and used for a County Hospital. Harrell is credited with performing one of the first blood transfusions in the state. He also served several terms as president of the Indiana Institute of Homeopathy.

Dr. Harrell provided emergency treatment in the parlor of the house, with patients entering through the porte-cochere entrance (which still displays the doctor's name in the stained glass). The house exhibits the typical features of the Queen Anne style, including the complex massing and roof, a polygonal tower, patterned slate roof and cresting, corbeled chimneys, and stained glass. Inside the house are elaborately carved oak woodwork and molded plaster ceilings. The house is in excellent condition, and was given a rating of "Outstanding" by the Indiana Historic Sites and Structures Inventory.

Samuel Harrell died in 1931, but the house remained in the family until 1970.

9. Major Bibliographical References

Foland, John. Remembrances. Noblesville: Rowland Printing Company, 1976.
 Indiana Department of Natural Resources. Indiana Historic Sites & Structures Inventory, 1978
 Indianapolis Star, September 10, 1931.
 The Noblesville Ledger, September 10, 1981.

10. Geographical Data

Acreeage of nominated property less than one acre

Quadrangle name Noblesville

Quadrangle scale 1:24000

UTM References

A

1	6
---	---

5	8	4	2	6	0
---	---	---	---	---	---

4	4	3	3	4	5	0
---	---	---	---	---	---	---

 Zone Easting Northing

B

--	--

--	--	--	--

--	--	--	--	--	--

 Zone Easting Northing

C

--	--

--	--	--	--

--	--	--	--	--	--

D

--	--

--	--	--	--

--	--	--	--	--	--

E

--	--

--	--	--	--

--	--	--	--	--	--

F

--	--

--	--	--	--

--	--	--	--	--	--

G

--	--

--	--	--	--

--	--	--	--	--	--

H

--	--

--	--	--	--

--	--	--	--	--	--

Verbal boundary description and justification Lots #1 and #2 of Square 2 in the Original Plat of Noblesville, recorded in Plat Book 1, Page 3, in the office of the Recorder of Hamilton County

List all states and counties for properties overlapping state or county boundaries

state N/A code county code

state code county code

11. Form Prepared By

name/title Sandra L. Elliott, Owner

organization N/A

date June 10, 1983

street & number 399 N. 10th Street

telephone 773-6403

city or town Noblesville

state Indiana 46060

12. State Historic Preservation Officer Certification

The evaluated significance of this property within the state is:

national state local

As the designated State Historic Preservation Officer for the National Historic Preservation Act of 1966 (Public Law 89-665), I hereby nominate this property for inclusion in the National Register and certify that it has been evaluated according to the criteria and procedures set forth by the National Park Service.

State Historic Preservation Officer signature

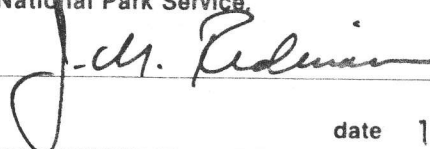

title State Historic Preservation Officer

date 1-24-84

For NPS use only

I hereby certify that this property is included in the National Register

date

Keeper of the National Register

Attest:

date

Chief of Registration

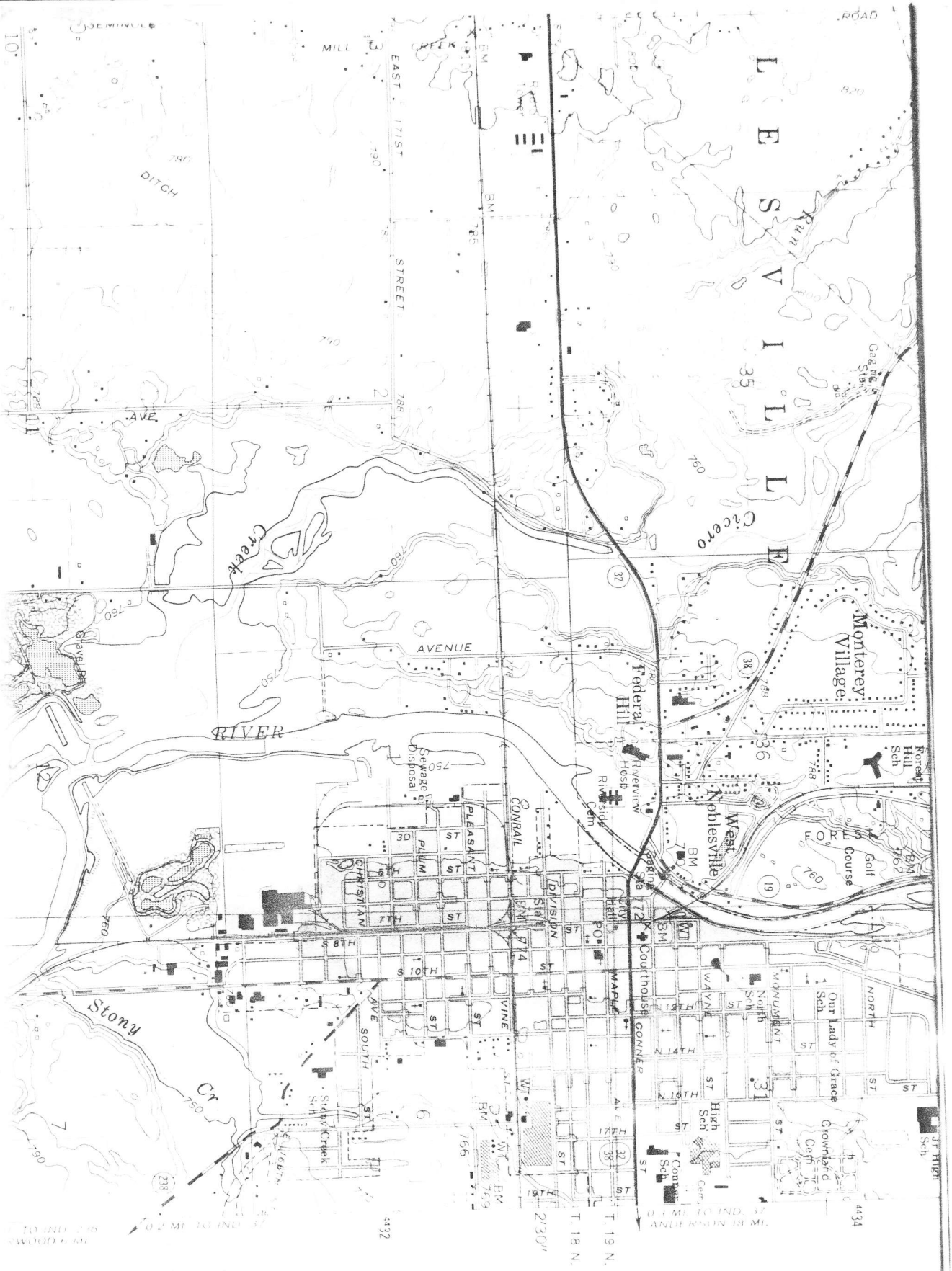

Harrell House
 Noblesville, Indiana
 UTM Reference: 16/584260/4433450