

FINAL

United States Department of the Interior
National Park Service

For NPS use only

National Register of Historic Places
Inventory—Nomination Form

received

date entered

See instructions in *How to Complete National Register Forms*
Type all entries—complete applicable sections

1. Name

historic Melville F. McHaffie Farm/Forest Home Stock Farm

and/or common Schuyler Arnold Seed Farm

2. Location

street & number Old National Road (U.S. 40) N/A not for publication

city, town Stilesville vicinity of

state Indiana code 018 county Putnam code 133

3. Classification

Category	Ownership	Status	Present Use
<input type="checkbox"/> district	<input type="checkbox"/> public	<input type="checkbox"/> occupied	<input type="checkbox"/> agriculture
<input checked="" type="checkbox"/> building(s)	<input checked="" type="checkbox"/> private	<input type="checkbox"/> unoccupied	<input type="checkbox"/> commercial
<input type="checkbox"/> structure	<input type="checkbox"/> both	<input checked="" type="checkbox"/> work in progress	<input type="checkbox"/> educational
<input type="checkbox"/> site	Public Acquisition	Accessible	<input type="checkbox"/> entertainment
<input type="checkbox"/> object	<input type="checkbox"/> in process	<input checked="" type="checkbox"/> yes: restricted	<input type="checkbox"/> government
	<input type="checkbox"/> being considered	<input type="checkbox"/> yes: unrestricted	<input type="checkbox"/> industrial
	N/A	<input type="checkbox"/> no	<input type="checkbox"/> military
			<input type="checkbox"/> museum
			<input type="checkbox"/> park
			<input checked="" type="checkbox"/> private residence
			<input type="checkbox"/> religious
			<input type="checkbox"/> scientific
			<input type="checkbox"/> transportation
			<input type="checkbox"/> other:

4. Owner of Property

name Mr. and Mrs. Walter L. Prosser

street & number 2431 Knollwood Drive

city, town Indianapolis N/A vicinity of state Indiana 46208

5. Location of Legal Description

courthouse, registry of deeds, etc. Putnam County Courthouse

street & number

city, town Greencastle state Indiana

6. Representation in Existing Surveys

title N/A has this property been determined eligible? yes no

date federal state county local

depository for survey records N/A

city, town state

7. Description

Condition

excellent

good

fair

deteriorated

ruins

unexposed

Check one

unaltered

altered

Check one

original site

moved

date

N/A

Describe the present and original (if known) physical appearance

The McHaffie Farm (photo 1) is located in a rural area on the border of Putnam and Hendricks Counties. The house and barn, which are both in Putnam County, face northwest on the National Road.

The Italianate house (photos 2-4) is a detached, two-story building of brick construction, faced with brick laid in Flemish-double-stretcher bond. There is a smooth stone water table around the base of the building. The house is cubic in form and has a hip roof. The principal (northwest) facade is five bays wide and the end facades are three bays wide.

The main entry (photo 2) consists of a recessed, segmental-arched opening and a wood glazed door with a segmental-arched transom and sidelights. There is a decorative bracket under the arch on each side of the transom. Both the recessed and the surface arch are framed by headers. Above the main entrance on the second floor is a similar door which formerly opened onto a balcony above a porch. The porch has been removed but its outline is visible on the brick facade. This was a columned, bracketed, wood porch which can be seen in an historic photograph. A low, concrete block wall around the porch, added later, has been removed by the present owners.

There is another entrance in the central bay of the southwest facade (photo 3). This entrance consists of a recessed, segmental-arched opening with a paneled, glazed door and segmental-arched transom. There was also a smaller porch here, visible in an historic photograph, which was similar to the one at the main entry. There is a door similar to this facade's first story door above it on the second story.

Windows are tall, narrow openings, also with recessed arches. Window sills are stone. Sash are double-hung with four lights in each.

At the top of the building is a wide frieze with paired, decorative brackets alternating with rectangular panels, and a molded box cornice which conceals the gutter. The roof is two colors of slate arranged in a decorative pattern. There is decorative, cast-iron cresting at the top of the roof. There are five chimneys.

The interior of the house is arranged around a stairway system (photo 6 and 7) which is composed of two cherry, banistered stairs ascending from hallways opening off the front and the east side doors to a common landing. From the landing, three stairs continue to the second floor.

Ceilings are 12'3" high. Woodwork (photo 5), of yellow poplar, is massive and ornate. Windows and doors have pediments above. Windows have full-length, paneled and louvered shutters of ash. Walls are sand-lime plaster on brick. Ceilings are plaster on wood lathe.

There is a two-bay cellar reached through a door and stairs adjacent to the east stairway. A brick, load-bearing wall with arched openings divides the cellar bays. The foundation is field stone capped with a smooth limestone sill.

The barn (photos 8-10), southwest of the house, is a two-story structure of brick laid in common bond, Flemish variation. The barn faces northwest, has a three-bay facade, a hip roof, and is rectangular in plan. In the central bay of the main facade (photos 7, 8) and on the opposite side (photo 9) is a large, round-arched barn door opening. On the first story on each side of these doors are segmental-arched door openings.

8. Significance

Period	Areas of Significance—Check and justify below			
<input type="checkbox"/> prehistoric	<input type="checkbox"/> archeology-prehistoric	<input type="checkbox"/> community planning	<input type="checkbox"/> landscape architecture	<input type="checkbox"/> religion
<input type="checkbox"/> 1400-1499	<input type="checkbox"/> archeology-historic	<input type="checkbox"/> conservation	<input type="checkbox"/> law	<input type="checkbox"/> science
<input type="checkbox"/> 1500-1599	<input checked="" type="checkbox"/> agriculture	<input type="checkbox"/> economics	<input type="checkbox"/> literature	<input type="checkbox"/> sculpture
<input type="checkbox"/> 1600-1699	<input checked="" type="checkbox"/> architecture	<input type="checkbox"/> education	<input type="checkbox"/> military	<input type="checkbox"/> social/
<input type="checkbox"/> 1700-1799	<input type="checkbox"/> art	<input type="checkbox"/> engineering	<input type="checkbox"/> music	<input type="checkbox"/> humanitarian
<input checked="" type="checkbox"/> 1800-1899	<input type="checkbox"/> commerce	<input type="checkbox"/> exploration/settlement	<input type="checkbox"/> philosophy	<input type="checkbox"/> theater
<input type="checkbox"/> 1900-	<input type="checkbox"/> communications	<input type="checkbox"/> industry	<input type="checkbox"/> politics government	<input type="checkbox"/> transportation
		<input type="checkbox"/> invention		<input type="checkbox"/> other (specify)

Specific dates 1870-1872 **Builder/Architect** Unknown

Statement of Significance (in one paragraph)

The McHaffie Farm is significant for its architecture. The house is an excellent, little-altered example of the Italianate style. Its size and grandeur have made it a prominent landmark on the National Road. The barn is of brick construction and displays unusual features such as round windows and a patterned slate roof. The farm is also significant as a well-known former Putnam County stock farm where first mules, and later race horses were raised.

The house was built in 1870-1872 at a cost of \$2,500.00 by Melville F. McHaffie (1826-1914), son of Putnam County pioneers. Melville raised mules and, according to his granddaughter, Maxine McHaffie Evans, received a personal commendation from President Lincoln for providing the Union Army with the largest number of mules during the Civil War.

Melville's son, Ernest, ran the farm--which he later inherited--as a breeding and training facility for race horses. He established the name, "Forest Home Stock Farm," around 1900. The farm was the home of the famous trotter, WWJ, who won many races at the Indiana State Fair in Indianapolis. Dan Patch was on the farm for breeding and training for a time around the turn of the century. He was also raced at the State Fair.

The farm was sold in 1934 to Schuyler Arnold, who turned the barn into a seed mill, which continued until his death in 1979.

The present owners purchased the farm in 1983 and are currently restoring both the house and the barn.

9. Major Bibliographical References

Please see continuation sheet

10. Geographical Data

Acreage of nominated property Approximately 4 acres

Quadrangle name Coatesville

Quadrangle scale 1:24,000

UTM References

A

1	6	5	2	9	1	3	0	4	3	8	6	5	2	0
Zone		Easting				Northing								

B

Zone		Easting				Northing								

C

Zone		Easting				Northing								

D

Zone		Easting				Northing								

E

Zone		Easting				Northing								

F

Zone		Easting				Northing								

G

Zone		Easting				Northing								

H

Zone		Easting				Northing								

Verbal boundary description and justification

Please see continuation sheet

List all states and counties for properties overlapping state or county boundaries

state Indiana code 018 county Putnam code 133

state Indiana code 018 county Hendricks code 063

11. Form Prepared By

name/title Mr. W. L. Prosser

organization Owner

date May 10, 1983

street & number 2431 Knollwood Drive

telephone 317/291-5092

city or town Indianapolis

state Indiana 46208

12. State Historic Preservation Officer Certification

The evaluated significance of this property within the state is:

national state local

As the designated State Historic Preservation Officer for the National Historic Preservation Act of 1966 (Public Law 89-665), I hereby nominate this property for inclusion in the National Register and certify that it has been evaluated according to the criteria and procedures set forth by the National Park Service.

State Historic Preservation Officer signature

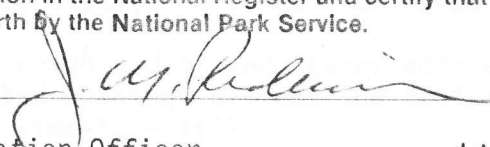

title Indiana State Historic Preservation Officer

date 11-7-83

For NPS use only

I hereby certify that this property is included in the National Register

date

Keeper of the National Register

Attest:

date

Chief of Registration

**United States Department of the Interior
National Park Service**

**National Register of Historic Places
Inventory—Nomination Form**

For NPS use only

received

date entered

Continuation sheet McHaffie Farm

Item number 7

Page 1

On the first story of each of the end facades are eight round windows (photo 10), one each for the horse stalls. Second-story windows on the barn are like those on the house. The roof, which, like the house, has two colors of slate arranged in a decorative pattern, has projecting eaves and exposed rafters. At the top of the roof is a belvedere which is covered with sheet metal. On the east side of the barn is a shed-roofed, frame addition.

There was formerly another barn, west of the present one, which was used to house race horses. Between the two buildings was a one-mile race track for training the horses.

McHaffie Farm

Item 9

Evans, Maxine McHaffie, Indianapolis, Indiana. Interview, July 28, 1983.

History of Hendricks County, Indiana. Chicago: Inter-State Publishing Company, 1885.

Niehaus, Charles. "Doom Averted for U.S. 40 Landmark," The Indiana Preservationist, March-April, 1983.

Weiks, Jesse W. History of Putnam County, Indiana. Indianapolis: B. F. Bowen and Company, 1910.

**United States Department of the Interior
National Park Service**

**National Register of Historic Places
Inventory—Nomination Form**

For NPS use only

received

date entered

Continuation sheet McHaffie Farm

Item number 10

Page 2

IN HENDRICKS COUNTY

Tract 1A

Beginning at a point on the South line of the Southeast quarter of Section 20, Township 14 North, Range 2 West, which point is 2604.47 feet westerly from the Southeast corner of said Southeast quarter; thence North 89° 30 minutes West with the South line of said Southeast Quarter and the South line of the Southwest quarter of said Section 20, to the South right-of-way of U.S. Highway 40; thence North 68° 27 minutes East with the South right-of-way of said U.S. Highway 40 to a point north 4° 26 minutes West of the point of beginning; thence South 4° 26 minutes East 80.80 feet to the point of beginning.

IN PUTNAM COUNTY

Tract 1B

Beginning at a point on the North line of the Northeast quarter of Section 29, Township 14 North, Range 2 West, which point is 2604.47' westerly from the Northeast corner of said Northeast quarter; thence South 4° 26 minutes East 384.94 feet; thence South 89° 52 minutes West 417.6 feet; thence North 7° 00 minutes West to the south right-of-way of U.S. Highway 40; thence North 68° 27 minutes East to the North line of the aforesaid Section 29; thence South 89° 30 minutes East with the North line of said Section 29 to the point of beginning, excluding, however, those portions of the described tracts that lie within the present right-of-way of U. S. Highway 40.

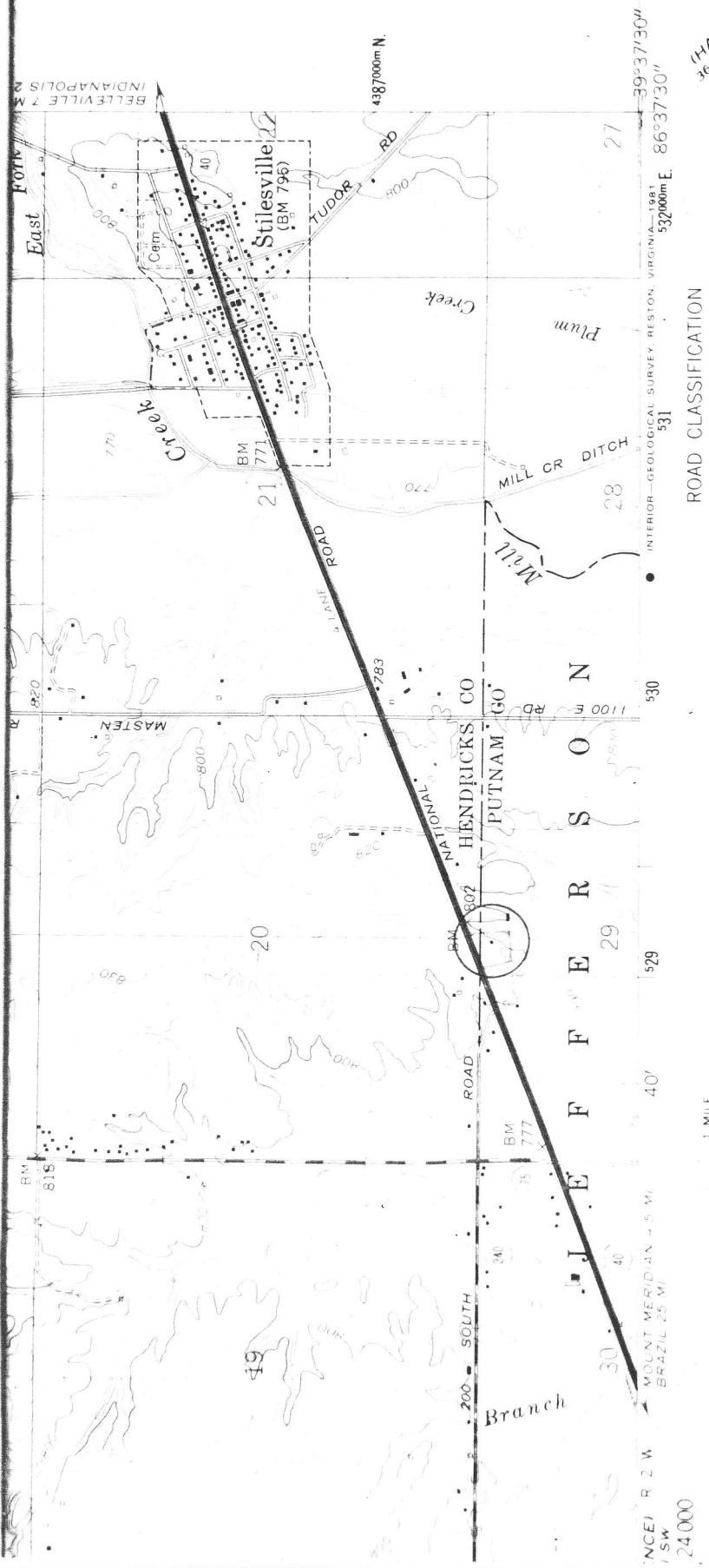

McHaffie Farm
vic. of Stilesville, Indiana
UTM Reference: 16/529130/4386520

ROAD CLASSIFICATION

- Primary highway, hard surface
- Light duty road, hard or improved surface
- Secondary highway, hard surface
- Unimproved road
- Interstate Route
- U. S. Route
- State Route

35 11 390E
(HALL)

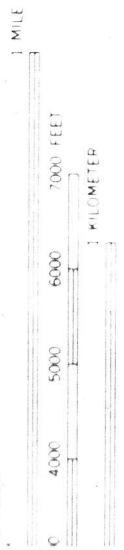

VERTICAL DATUM OF 1929

COATESVILLE, IND.
N3937.5—W8637.5/7.5

QUADRANGLE LOCATION



Revisions shown in purple compiled in cooperation with State of Indiana agencies from aerial photographs taken 1977 and other source data. This information not field checked. Map edited 1980

NATIONAL MAP ACCURACY STANDARDS
SURVEY, RESTON, VIRGINIA 22092
RESOURCES, INDIANAPOLIS, INDIANA 46204
AND SYMBOLS IS AVAILABLE ON REQUEST

1970
PHOTOREVISED 1980
DMA 3663 II NW—SERIES V851