

**United States Department of the Interior  
National Park Service**

For NPS use only

**National Register of Historic Places  
Inventory—Nomination Form**

received

date entered

See instructions in *How to Complete National Register Forms*  
Type all entries—complete applicable sections

**1. Name**

historic Ferguson House

and/or common Dr. Robert A. Brewer House

**2. Location**

street & number 803 East Broadway

N/A not for publication

city, town Logansport

N/A vicinity of

state Indiana

code 018

county Cass

code 017

**3. Classification**

Category	Ownership	Status	Present Use
<input type="checkbox"/> district	<input type="checkbox"/> public	<input checked="" type="checkbox"/> occupied	<input type="checkbox"/> agriculture
<input checked="" type="checkbox"/> building(s)	<input checked="" type="checkbox"/> private	<input type="checkbox"/> unoccupied	<input type="checkbox"/> commercial
<input type="checkbox"/> structure	<input type="checkbox"/> both	<input type="checkbox"/> work in progress	<input type="checkbox"/> educational
<input type="checkbox"/> site	<b>Public Acquisition</b>	<b>Accessible</b>	<input type="checkbox"/> entertainment
<input type="checkbox"/> object	<input type="checkbox"/> in process	<input checked="" type="checkbox"/> yes: restricted	<input type="checkbox"/> government
	<input type="checkbox"/> being considered	<input type="checkbox"/> yes: unrestricted	<input type="checkbox"/> industrial
	N/A	<input type="checkbox"/> no	<input type="checkbox"/> military
			<input type="checkbox"/> museum
			<input type="checkbox"/> park
			<input checked="" type="checkbox"/> private residence
			<input type="checkbox"/> religious
			<input type="checkbox"/> scientific
			<input type="checkbox"/> transportation
			<input type="checkbox"/> other:

**4. Owner of Property**

name Dr. and Mrs. Robert A. Brewer

street & number 803 E. Broadway

city, town Logansport

N/A vicinity of

state Indiana 46947

**5. Location of Legal Description**

courthouse, registry of deeds, etc. Cass County Recorder's Office

street & number 200 Court Park

city, town Logansport

state Indiana 46947

**6. Representation in Existing Surveys**

title Indiana Historic Sites and Structures Inventory

has this property been determined eligible?  yes  no

date 1981

federal  state  county  local

depository for survey records Indiana Department of Natural Resources

city, town Indianapolis

state Indiana

## 7. Description

<b>Condition</b>		<b>Check one</b>	<b>Check one</b>	
<input type="checkbox"/> excellent	<input type="checkbox"/> deteriorated	<input type="checkbox"/> unaltered	<input checked="" type="checkbox"/> original site	
<input checked="" type="checkbox"/> good	<input type="checkbox"/> ruins	<input checked="" type="checkbox"/> altered	<input type="checkbox"/> moved	date <u>N/A</u>
<input type="checkbox"/> fair	<input type="checkbox"/> unexposed			

### Describe the present and original (if known) physical appearance

The Ferguson House sits on a corner facing a major thoroughfare on the edge of the commercial district of Logansport. The three-story private home is constructed of red brick and sheathed in rockfaced Indiana limestone, which was finished on the site, according to Mrs. Frances Bradfield, who played on the large blocks of limestone as a young girl. Massive design elements and round arches suggest the Richardsonian Romanesque style (photo 1). The body of the house is laid in random ashlar with the projecting bays and towers having coursed ashlar. The steeply pitched, charcoal gray, shingled roof has replaced the original slate. The ridges are covered with overlapping pieces of horizontally laid tin cones, with tin finials.

The main facade is dominated by a one-story Classical porch, supported by Doric columns with a bracketed cornice and a pediment over the main entrance. The porch floor is original and made of colored slate tiles in a geometric pattern.

Centered above the main entrance is an arched window, sheltered by an awning supported by scrolled wooden brackets. Above the awning is a gabled wall dormer flanked by narrow stone tourelles. The tourelles and the gable end are made of small squares of limestone. At the peak of the hipped roof, centered over the gabled dormer, is a large, galvanized tin finial embellished with scrollwork and a large letter "F".

To the left of the main entrance is a broad, fixed sash window with a stained glass transom. Above this, at the second story, is a pair of double-hung sash windows. Stone sills and lintels project slightly on all windows of the house. Above the second story is a plain entablature and bracketed cornice.

To the right of the main entrance is a 2 1/2 story round tower with a conical roof. The tower has three bays, each with a curved, double-hung window on each floor. At the second story these bays are separated by smooth, engaged limestone columns. The uppermost part of each column has a leafy-type design, and above the roof line each column has a galvanized tin finial. A small dormer is above the center bay. The cone roof is topped by a tall, hyacinth-shaped tin finial.

The west facade, which faces Eighth Street has, in addition to the corner tower, two projecting bays (photos 2 and 3). The largest, located in the center, features a large, fixed-sash window with a stained glass transom on the first floor and an arched pair of windows on the second floor. The southernmost projecting bay is smaller and surrounded by a one-story, curved porch supported by Doric columns. The second story porch, which was identical to the first story, was removed circa 1940.

The east facade is not seen from the street. A curved projection contains the fireplace chimney, flanked by stained glass windows on the first story and slightly curved, double-hung sash windows on the second. South of this chimney are three stepped, double-hung, stained glass windows which light the staircase. Above these windows, lighting the staircase to the third story, is a double-hung, stained glass window, flanked by two smaller stained glass windows.

## 8. Significance

Period	Areas of Significance—Check and justify below			
<input type="checkbox"/> prehistoric	<input type="checkbox"/> archeology-prehistoric	<input type="checkbox"/> community planning	<input type="checkbox"/> landscape architecture	<input type="checkbox"/> religion
<input type="checkbox"/> 1400–1499	<input type="checkbox"/> archeology-historic	<input type="checkbox"/> conservation	<input type="checkbox"/> law	<input type="checkbox"/> science
<input type="checkbox"/> 1500–1599	<input type="checkbox"/> agriculture	<input type="checkbox"/> economics	<input type="checkbox"/> literature	<input type="checkbox"/> sculpture
<input type="checkbox"/> 1600–1699	<input checked="" type="checkbox"/> architecture	<input type="checkbox"/> education	<input type="checkbox"/> military	<input type="checkbox"/> social/ humanitarian
<input type="checkbox"/> 1700–1799	<input type="checkbox"/> art	<input type="checkbox"/> engineering	<input type="checkbox"/> music	<input type="checkbox"/> theater
<input checked="" type="checkbox"/> 1800–1899	<input type="checkbox"/> commerce	<input type="checkbox"/> exploration/settlement	<input type="checkbox"/> philosophy	<input type="checkbox"/> transportation
<input type="checkbox"/> 1900–	<input type="checkbox"/> communications	<input type="checkbox"/> industry	<input type="checkbox"/> politics/government	<input type="checkbox"/> other (specify)
		<input type="checkbox"/> invention		

**Specific dates** circa 1895 **Builder/Architect** Unknown

### Statement of Significance (~~in one paragraph~~)

The Ferguson House is significant for its architecture and for its association with John D. Ferguson, one of the city's leading businessmen during the late 19th and early 20th centuries. Ferguson, an entrepreneur involved in several different professions, is best remembered for his extensive property holdings, which included some of downtown Logansport's most prominent buildings. The house which he constructed around 1895 is a large structure whose design demonstrates the influence of the Richardsonian Romanesque style. It is thought to be the only residence in the city which features rock-faced limestone veneer, in this style.

John D. Ferguson was born in Cass County in 1846 and came to Logansport in the late 1860's. He learned the bakery trade and established his own bakery in 1877. He then expanded to the restaurant business. Later, he became engaged in the clothing business, and he also became involved in real estate and insurance. Several of Logansport's largest business establishments occupied buildings either built or remodeled by Ferguson. He and his wife owned the buildings occupied by the F. W. Woolworth Company, the J. C. Penney Company, the Seybold Dry Goods Company, the Logansport Theater Corporation, and the Adams Express Company. Ferguson also owned 147 acres south of Logansport and other properties elsewhere in the state. Ferguson died in 1922, but the house remained in family hands until 1962, when it was given to the Calvary Presbyterian Church. The present owners purchased the property in 1969.

The home's exterior features the massiveness of design, the rounded-arch openings, and the ashlar construction normally associated with the Richardsonian Romanesque style. The interior of the home retains most of its original features, including the elaborate fireplace surrounds, the ornate woodwork, several stained glass windows, and a number of original bathroom fixtures. The home is situated on a major thoroughfare at the edge of the city's commercial district, and remains a prominent local landmark.

# 9. Major Bibliographical References

Please see continuation sheet

# 10. Geographical Data

Acreeage of nominated property Less than one acre

Quadrangle name Logansport Quadrangle

Quadrangle scale 1:24000

UTM References

A 

1	6	5	5	4	0	5	0	4	5	1	1	5	4	0
Zone		Easting				Northing								

B 

Zone		Easting				Northing								

C 

Zone		Easting				Northing								

D 

Zone		Easting				Northing								

E 

Zone		Easting				Northing								

F 

Zone		Easting				Northing								

G 

Zone		Easting				Northing								

H 

Zone		Easting				Northing								

Verbal boundary description and justification

Please see continuation sheet

List all states and counties for properties overlapping state or county boundaries

state N/A code county code

state code county code

# 11. Form Prepared By

name/title Marta J. Brewer

organization N/A date 10-31-82

street & number R. 2, Box 264 telephone 219/889-4115

city or town Lucerne state Indiana 46950

# 12. State Historic Preservation Officer Certification

The evaluated significance of this property within the state is:

national  state  local

As the designated State Historic Preservation Officer for the National Historic Preservation Act of 1966 (Public Law 89-665), I hereby nominate this property for inclusion in the National Register and certify that it has been evaluated according to the criteria and procedures set forth by the National Park Service.

State Historic Preservation Officer signature 

title Indiana State Historic Preservation Officer date 5-16-83

For NPS use only

I hereby certify that this property is included in the National Register

date

Keeper of the National Register

Attest:

date

Chief of Registration

**United States Department of the Interior  
National Park Service**

**National Register of Historic Places  
Inventory—Nomination Form**

For NPS use only  
received  
date entered

Continuation sheet Ferguson House

Item number 7

Page 1

The rear of the house has a recently remodeled porch. It is enclosed, as was the previous one. The original porch had wooden lattice instead of windows.

Inside, the floorplan is formal. The front entrance opens from the veranda to a tiled vestibule. Both veranda and vestibule are floored with original ceramic tiles, set in geometric patterns and borders. The vestibule opens to an inner entry hall. The music room is situated to the left of the entry hall, and the divided parlor and sitting room are to the right. The entry hall opens to a large, central stair hall. Off the stair hall, under the staircase, a half-bath with original marble fixtures is still in place. The formal dining room, service area and kitchen lead from the stair hall. A butler's pantry is off the dining room. Off the kitchen, in addition to the service area, is located a large, walk-in pantry. Situated behind the kitchen is the large enclosed back porch. At the west entrance is the servant's staircase, quite unusual in that it is an elaborate spiral. Continuing to the basement on the servant's staircase, the chauffeur's apartment is still in place. Behind the chauffeur's quarters is a full-length basement that is divided into small rooms.

The main entrance is equipped with original, double oak screen doors with lower glass panels. The screen doors open to heavy oak, double entry doors which have unusual concave panels (photo 4). The inner entry door is a double sliding assembly, which matches the other pocket doors that close off the sitting room, front parlor, and dining room from the entry hall and central stair hall. All brasses are heavy, elaborate, and original. The floors and woodwork on both the upper and lower levels are all original, and have been restored, in a few instances, to retain the appearance of the original finish. With the exception of the kitchen and servants' quarters, oak door and window encasements on both floors are topped with a dentiled entablature (photo 5). On the lower level in the front part of the house, these entablatures are topped by an additional horizontal lathed piece with carved ends (photo 6).

The music room contains a shallow gas jet fireplace with full-height, birds-eye maple mantel, relief carved with swags, rosettes and wreaths (photo 6). The mantel is topped by a large, beveled glass mirror, and flanked on both sides by small, stained glass windows. Complementing those windows, a matching, stained glass transom, about 6' x 2', tops the large music room window. The cast iron fire front is decorated in relief with a pastoral scene, and the original dusty rose-colored fireplace tiles are in a blackberry motif.

The parlor fireplace mantel is full-height oak, with a large beveled mirror and fluted columns topped with carved capitals (photo 7). Hearth tile is pale blue with a geometrically patterned tile border. The original coal-burning fireplace has been replaced with a gas log. The iron fire front is cast in a Rococco pattern. A 6' x 2' stained glass panel, matching the one in the music room, tops a large clear window on the west side of the room. The sitting room, where the corner tower is located, and front parlor are separated by a large, oak-encased, open doorway as described above. The corner tower on both the upper and lower levels contains curved steam radiators.

The central stair hall occupies the core of the lower floor, and is 20' square. The staircase is oak (photo 8), with scrollsawn fans which complement the surviving, plaster applique wainscoting, done in a stylized chrysanthemum pattern. The decoratively carved

**United States Department of the Interior  
National Park Service**

**National Register of Historic Places  
Inventory—Nomination Form**

For NPS use only

received

date entered

Continuation sheet Ferguson House

Item number 7

Page 2

newel post at the bottom of the stairs carries an embellished, original post lamp with central electric globe and three branch gas burners. The post lamp is brass, with very unusual ornamentation. The first landing on the staircase contains three large, stepped, double-hung, stained glass windows, which help illuminate the landing and the stair hall. The fireplace in the central stair hall is also equipped with an original, full-height mantel of oak, with fluted columns and beveled glass mirror (photo 9). The mantel is carved with stylized chrysanthemum patterns, and the golden-tan floor tiles are in geometric florals.

The dining room is entered from the central stair hall. The steam radiator in the room is equipped with a very unusual, double-door warming oven (photo 10). The china closet, just off the dining room, retains the original pine cabinets with brass pulls and hardware, glass front china cabinets, and car-side wainscoting. The butler's pantry has a connecting cupboard to the service area so as to bypass the dining area. The dining room fireplace features mottled green tiles and cast bronze fire front, with stylized female figures complementing relief cast scrolling (photo 11). Originally a coal-burning fireplace, it is now equipped with a gas log. The mantel is columned and carved in a stylized palm frond motif which complements the original plaster applied, foot-wide wall borders that are three feet from the floor.

The kitchen, reached from a service extension of the dining room containing the laundry chute, linen storage drawers and kitchen service cabinets, was paneled in knotty pine tongue-and-groove, circa 1940. The original servant's call system services three entrances, the stair hall, and all upstairs bedrooms, except the maid's room.

The servant's staircase is unusually ornate with a curved pine bannister and a carved newel post topped by a large finial (photo 12). Curved pine wainscoting skirts the base of the staircase in the small stair hall. The original electrified gas lamp is made of brass with a teardrop, milk glass globe and curved arm which holds a single gas burner. It hangs from a single brass pole. The chauffeur's apartment is down the back staircase in the basement. The original marble basin in the washroom of these quarters matches the basin in the central stair hall bathroom. Behind the chauffeur's quarters in the full-length basement, 32' walnut floor supports can be seen. The original laundry tubs and laundry chute are in the central basement room. The house also retains its original plumbing.

Going up the back staircase, the walk-in linen closet and second story porch entry door are off the upper landing. The maid's quarters are adjacent to the upper landing. The maid's bathroom contains the original tub with marble, block-stepped feet, in company with the original massive, nickel-plated faucets and fixtures. The maid's bedroom has a molded plaster-coated wooden picture rail.

The upstairs back hall floor is done in 6" pine plank. The upper back hall contains an original service linen closet with copper drawer pulls and a laundry chute which leads, in common with the chute in the kitchen service area, to the basement laundry. A remodeled bathroom is off the back hall to the east.

**United States Department of the Interior  
National Park Service**

**National Register of Historic Places  
Inventory—Nomination Form**

For NPS use only

received

date entered

Continuation sheet Ferguson House

Item number 7

Page 3

The second floor landing from the central staircase is quite large, and actually amounts to another central stair hall. Oak columns carry the cantilevered load of the second story stair hall to the third floor structure with minimum disruption of floor space. The staircase continues, in full ornamentation, to a final, smaller landing at the attic level. A stained glass, double-hung window, flanked by matching stained glass panels, illuminates the central hall at the second floor level. The stained glass pattern matches the windows on the lower level staircase and the panels in the music room. A molded plaster coated picture rail runs 16" below the ceiling. The third floor, full-length attic was completely finished in 1973.

The corner tower, with three curved glass windows, continues from the lower floor front sitting room to the master bedroom on the second floor. Opposite the entrance door is a large arched window, facing north. To the left of the window is a wall that turns into the room with lathed oak corner protectors that come halfway up the wall. The original picture rail, as previously described, is still in place.

The master bathroom and a large walk-through closet each connect the master bedroom to the study. The main entrance to the study is from the upper stair hall. Opposite the main entrance door is a large arched window matching the window in the master bedroom. The study is equipped with an original, built-in bookcase and a picture rail.

A second bedroom leads from the upper stair hall adjacent to the back hallway.

The morning room, adjacent to the master bedroom, contains a shallow fireplace with oak mantel carved in a pomegranate motif, along with elaborate fretwork (photo 13). Oval beveled mirrors flank a central rectangular mirror in the upper section of the mantel. The fireplace tiles are golden-tan in color and the original gas jet is present, although not usable at this time. A marble wash basin, with wrought iron supports, is mounted in the corner of the room. In addition to the picture rail, an original, 1/2" plaster molding frames the ceiling.

United States Department of the Interior  
National Park Service

National Register of Historic Places  
Inventory—Nomination Form

For NPS use only  
received  
date entered

Continuation sheet Ferguson House

Item number 9

Page 4

Abstract of Title, Markley Abstract Co., Logansport, owner's possession.

Cass County, Indiana Appraisement List and Transfers of Real Estate, Cass County Assessor's Office, 1891-1895, and 1895-1899.

Cass County, Indiana Miscellaneous Records, Cass County Recorder's Office, Vols. 10, 11, 12, 17, 28. 1905-1938.

Cornelius, L'Dean and Julian, R. W., ed. Where Two Rivers Meet, The Cass County Historical Society, Logansport, 1978. Photograph 36.

Interview of Mrs. Frances Bradfield by Mrs. Robert A. Brewer, 1969.

Logansport City Directories, 1876+.

The Pharos Tribune and Press, August 5, 1922, Logansport, Indiana. Obituary

Powell, Dr. Jehu Z., ed. The History of Cass County, Indiana. Chicago and New York: The Lewis Publishing Company. 1913, page 1201



**United States Department of the Interior  
National Park Service**

**National Register of Historic Places  
Inventory—Nomination Form**

For NPS use only

received

date entered

Continuation sheet

Ferguson House

Item number 10

Page 5

West Two-Thirds (2/3) of Lot number One Hundred Twenty-One (121) in John Tipton's Fourth Addition to the City of Logansport; also, the West Three feet and six inches (3'6") of the East One-third (1/3) of Lot number One Hundred Twenty-One (121) in John Tipton's Fourth Addition to the City of Logansport. Bounded on the north by East Broadway and the west by Eighth Street, it sits on a corner at the east edge of Logansport's business district, Cass County, Indiana

John D. Ferguson House  
 Logansport, Indiana  
 UTM Reference: 16/554050/4511540

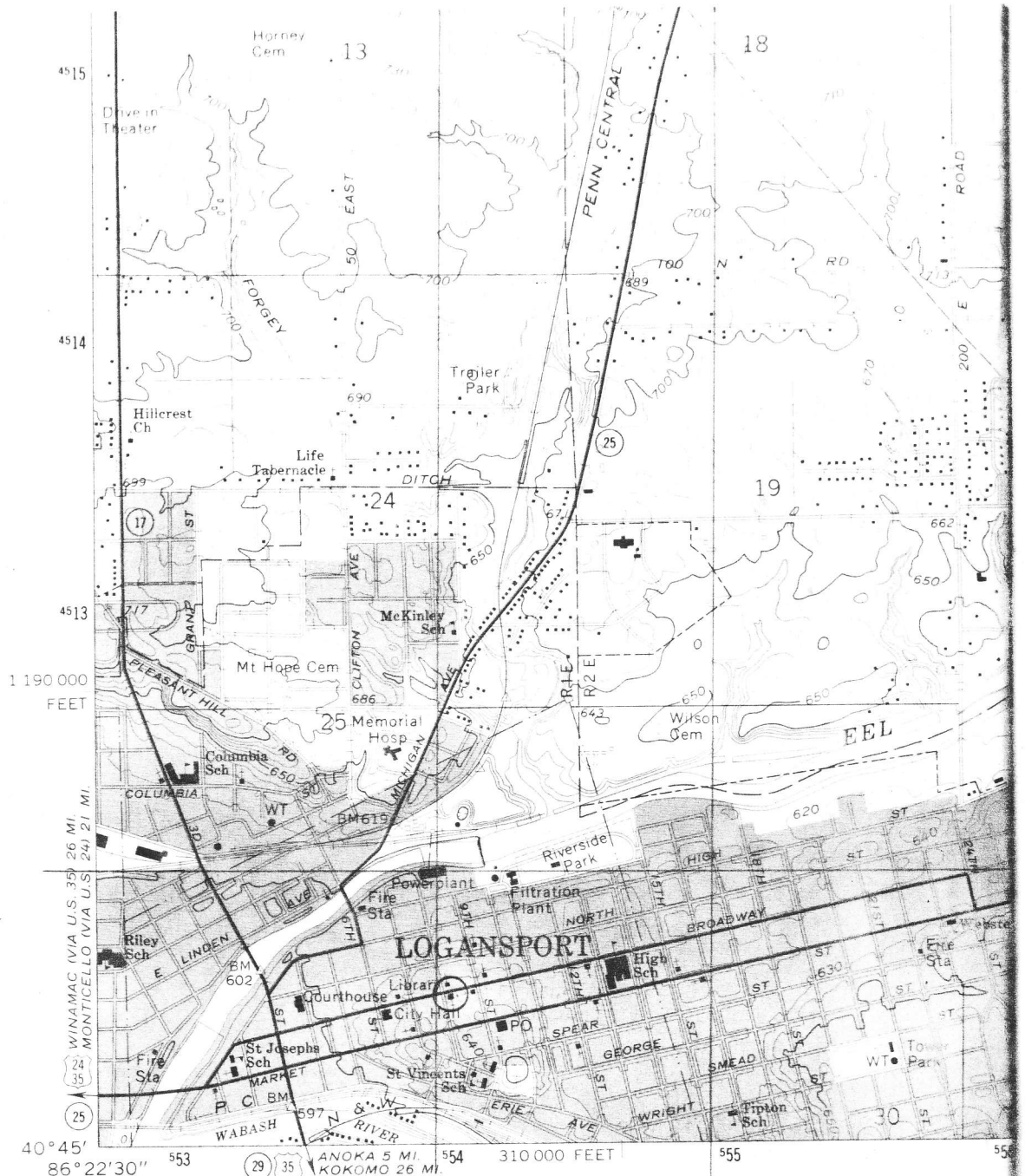

(CLYMERS)  
 3765 III NW

Mapped, edited, and published by the Geological Survey  
 Control by USGS, USC&GS and USCE

Planimetry by photogrammetric methods from aerial photographs  
 taken 1948. Topography by planetable surveys 1955  
 Revised from aerial photographs taken 1971. Field checked 1972

Polyconic projection. 1927 North American datum  
 10,000-foot grid based on Indiana coordinate system,  
 east zone  
 1000-meter Universal Transverse Mercator grid ticks,  
 zone 16, shown in blue

Fine red dashed lines indicate selected fence and field lines where  
 generally visible on aerial photographs. This information is unchecked

Red tint indicates areas in which only landmark buildings are shown

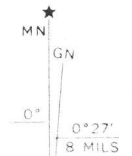

UTM GRID AND 1972 MAGNETIC  
 DECLINATION AT CENTER OF S