

United States Department of the Interior  
National Park Service

For NPS use only

National Register of Historic Places  
Inventory—Nomination Form

received

date entered

See instructions in *How to Complete National Register Forms*  
Type all entries—complete applicable sections

1. Name

historic Davenport-Bradfield House

and or common Bradfield House

2. Location

street & number 106 E. Second Street

N/A not for publication

city, town Sheridan

N/A vicinity of

state Indiana

code 018

county Hamilton

code 057

3. Classification

Category	Ownership	Status	Present Use
<input type="checkbox"/> district	<input type="checkbox"/> public	<input checked="" type="checkbox"/> occupied	<input type="checkbox"/> agriculture
<input checked="" type="checkbox"/> building(s)	<input checked="" type="checkbox"/> private	<input type="checkbox"/> unoccupied	<input type="checkbox"/> commercial
<input type="checkbox"/> structure	<input type="checkbox"/> both	<input type="checkbox"/> work in progress	<input type="checkbox"/> educational
<input type="checkbox"/> site	<b>Public Acquisition</b>	<b>Accessible</b>	<input checked="" type="checkbox"/> private residence
<input type="checkbox"/> object	<input type="checkbox"/> in process	<input checked="" type="checkbox"/> yes: restricted	<input type="checkbox"/> religious
	<input type="checkbox"/> being considered	<input type="checkbox"/> yes: unrestricted	<input type="checkbox"/> scientific
	N/A	<input type="checkbox"/> no	<input type="checkbox"/> transportation
			<input type="checkbox"/> other:

4. Owner of Property

name Kenneth G. and Sheila Young

street & number 106 E. Second Street

city, town Sheridan

N/A vicinity of

state Indiana 46069

5. Location of Legal Description

courthouse, registry of deeds, etc. Recorder's Office

street & number Hamilton County Courthouse

city, town Noblesville

state Indiana 46060

6. Representation in Existing Surveys

title Indiana Historic Sites  
and Structures Inventory

has this property been determined eligible?  yes  no

date 1978

federal  state  county  local

depository for survey records Indiana Department of Natural Resources

city, town Indianapolis

state Indiana

## 7. Description

<b>Condition</b>		<b>Check one</b>	<b>Check one</b>
<input type="checkbox"/> excellent	<input type="checkbox"/> deteriorated	<input type="checkbox"/> unaltered	<input checked="" type="checkbox"/> original site
<input checked="" type="checkbox"/> good	<input type="checkbox"/> ruins	<input checked="" type="checkbox"/> altered	<input type="checkbox"/> moved date <u>N/A</u>
<input type="checkbox"/> fair	<input type="checkbox"/> unexposed		

### Describe the present and original (if known) physical appearance

The Davenport-Bradfield House is a two story brick, Italianate style structure located on the near northside of Sheridan, Indiana. Constructed for a local physician in 1875, the home features an irregular plan, a hipped roof, and a large decorative porch. The present owners, who purchased the property in late 1978, are currently restoring the structure.

It is thought that, when constructed, the home's main entry was the doorway located on the north facade. This narrow facade is two bays wide, and features paired, double-hung, rectangular windows in the east bay on both floor levels. A single-leaf entry door appears in the ground floor west bay, and a single, double-hung, rectangular window is contained in the second floor west bay. Both the door and the windows are contained in segmental-arched openings with brick voussoirs; the windows also feature limestone sills. The cornice features a narrow plain frieze and scroll-cut modillions.

Sometime in the 1920's the orientation of the house was changed so that the east elevation became the main facade. The current main entry, flanked by sidelights, is located in the center of the projecting area at the north end of this facade. Large, segmental-arched openings containing paired rectangular, double-hung windows appear in the bays on either side of the entry, and also in the corresponding bays on the second floor. The cornice detailing employed on the north facade is repeated on the east facade and on around the rest of the structure.

Perhaps the most decorative element of the house is the large porch which stretches across the entire east facade. This one-story porch features a sloping roof supported by turned wood posts. Scroll-sawn brackets and modillions, turned pendants, and a paneled frieze are used throughout this porch.

Besides the change in the orientation of the main facade, several other alterations were made to the house in the 1920's. A porch addition was built on the west facade near the back of the house, and a small sun porch was installed on the south (rear) facade. A narrow, one-car garage was also constructed as an extension of the one-story wing which projects from the rear (south) facade. On the interior, two large rooms on the second floor were each divided in half, yielding four small bedrooms, with walk-in closets. The claw-foot bathtub originally in the downstairs bathroom was relocated to a new bathroom that was installed on the second floor. Some changes in the location of doorways were also made at this time.

Since their purchase of the property in 1978, the current owners have replaced the deteriorated roof, repaired and repainted the porch, and removed the vines which obscured the entire north facade. In the near future they hope to strip off and replace all of the old wallpaper, refinish the floors and woodwork, and repair various sections of broken plaster.

## 8. Significance

Period	Areas of Significance—Check and justify below			
<input type="checkbox"/> prehistoric	<input type="checkbox"/> archeology-prehistoric	<input type="checkbox"/> community planning	<input type="checkbox"/> landscape architecture	<input type="checkbox"/> religion
<input type="checkbox"/> 1400–1499	<input type="checkbox"/> archeology-historic	<input type="checkbox"/> conservation	<input type="checkbox"/> law	<input type="checkbox"/> science
<input type="checkbox"/> 1500–1599	<input type="checkbox"/> agriculture	<input type="checkbox"/> economics	<input type="checkbox"/> literature	<input type="checkbox"/> sculpture
<input type="checkbox"/> 1600–1699	<input checked="" type="checkbox"/> architecture	<input type="checkbox"/> education	<input type="checkbox"/> military	<input type="checkbox"/> social/
<input type="checkbox"/> 1700–1799	<input type="checkbox"/> art	<input type="checkbox"/> engineering	<input type="checkbox"/> music	<input type="checkbox"/> humanitarian
<input checked="" type="checkbox"/> 1800–1899	<input type="checkbox"/> commerce	<input type="checkbox"/> exploration settlement	<input type="checkbox"/> philosophy	<input type="checkbox"/> theater
<input type="checkbox"/> 1900–	<input type="checkbox"/> communications	<input checked="" type="checkbox"/> industry	<input type="checkbox"/> politics government	<input type="checkbox"/> transportation
		<input type="checkbox"/> invention		<input checked="" type="checkbox"/> other (specify) Medicine
<b>Specific dates</b>	1875	<b>Builder/Architect</b>	Unknown	

### Statement of Significance (in one paragraph)

The Davenport-Bradfield House is significant for its architecture and for its association with some of Sheridan's most prominent citizens. A simple brick Italianate structure with an ornate porch, this 1875 home was originally built for one of Sheridan's early physicians. Subsequent owners included a local industrialist and a long-time local businessman.

The Davenport-Bradfield House features the irregular massing, hipped roof, and segmental-arched openings typical of Italianate homes of the late 19th century. Although some modifications and additions have been made to the structure, the major (i.e., north and east) facades remain relatively unchanged. Of particular interest is the porch on the east facade which features turned posts, scroll-sawn trim, decorative brackets and a paneled frieze.

The house was constructed in 1875 by Henderson E. Davenport, a Civil War veteran who graduated from medical school in 1872. He established his practice in Millwood (renamed Sheridan in the 1880's) shortly after graduation, and soon became locally prominent. He is best remembered for his role as one of the founders of the Hamilton County Medical Society. Davenport remained in this house until his death in 1909.

Davenport's widow sold the home to William N. Wilson, the founder of the Indiana Condensed Milk Company. This company was to become one of Sheridan's largest and longest-lived industries, but while it was still in its infancy, Wilson was killed in an industrial accident. His son, Taylor Wilson, who succeeded William Wilson as head of the company, inherited the home and sold it in 1917.

Joseph L. Vickery, who purchased the home from Wilson, owned and operated the Vickery Coal and Oil Company. It was during his ownership that several modifications were made to the house, including the addition of a garage, two small porches, and an additional bathroom.

Walter Bradfield purchased the home in 1926. Bradfield had operated a bicycle and gun store since 1898, but became well-known, locally, after 1903 when, with his brother-in-law, he established a harness-making business. Bradfield resided in the house for 52 years, until his death in 1978. The current owners acquired the home in 1978 and have since been working on the restoration of the structure.

# 9. Major Bibliographical References

Please see continuation sheet

# 10. Geographical Data

Acreeage of nominated property Less than one acre

Quadrangle name Sheridan

Quadrangle scale 1:24000

UTM References

A 

1	6	5	6	6	4	8	0	4	4	4	3	0	4	0
Zone		Easting				Northing								

B 

Zone		Easting				Northing								

C 

Zone		Easting				Northing								

D 

Zone		Easting				Northing								

E 

Zone		Easting				Northing								

F 

Zone		Easting				Northing								

G 

Zone		Easting				Northing								

H 

Zone		Easting				Northing								

**Verbal boundary description and justification** Beginning at the southwest corner of the intersection of East Second Street and Georgia Street, then proceeding south 132' along the west right-of-way line of East Second Street; then west 84.66'; then north 132' to the south right-of-way line of Georgia Street; then east 84.66' along that line to the point of beginning.

List all states and counties for properties overlapping state or county boundaries

state	code	county	code
N/A			

state	code	county	code

# 11. Form Prepared By

name/title Sheila Young

organization N/A date July 20, 1980

street & number 106 E. Second Street telephone 317/758-6565

city or town Sheridan state Indiana 46069

# 12. State Historic Preservation Officer Certification

The evaluated significance of this property within the state is:

national  state  local

As the designated State Historic Preservation Officer for the National Historic Preservation Act of 1966 (Public Law 89-665), I hereby nominate this property for inclusion in the National Register and certify that it has been evaluated according to the criteria and procedures set forth by the National Park Service.

State Historic Preservation Officer signature *Jane T. Costello*

title Indiana State Historic Preservation Officer date 12-4-84

For NPS use only

I hereby certify that this property is included in the National Register

date

Keeper of the National Register

Attest:

date

Chief of Registration

United States Department of the Interior  
National Park Service

**National Register of Historic Places  
Inventory—Nomination Form**

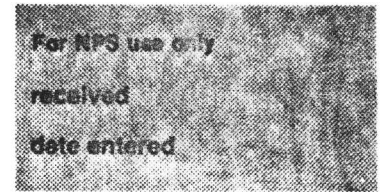

Davenport-  
Continuation sheet Bradfield House

Item number 9

Page 1

Dittrich, Tom. "Sheridan Couple Remodel 100-Year-Old Home." The Topics, January 16, 1980, p. 5.

Dunn, Jacob Pratt, ed. Representative Citizens of Indiana. Indianapolis: Bowen, 1912.

Haines, John F. History of Hamilton County. Indianapolis: Bowen, 1915.

Helm, T. B., ed. History of Hamilton County, Indiana. Chicago: Kingman, 1880.

History of Hamilton County, Indiana. Evansville, Indiana: Unigraphics, 1967.

Indiana Historical Society Library, comp. Indiana Biographical Series, V. 8, pp. 75-76.

Sheridan Centennial Committee, comp. Sheridan Centennial Souvenir Booklet. Sheridan, Indiana: 1960.

The Sheridan News, June 23, 1960, Section 2.

Davenport-Bradfield House  
 106 E. Second St., Sheridan, Indiana  
 UTM Reference: 16/566480/4443040

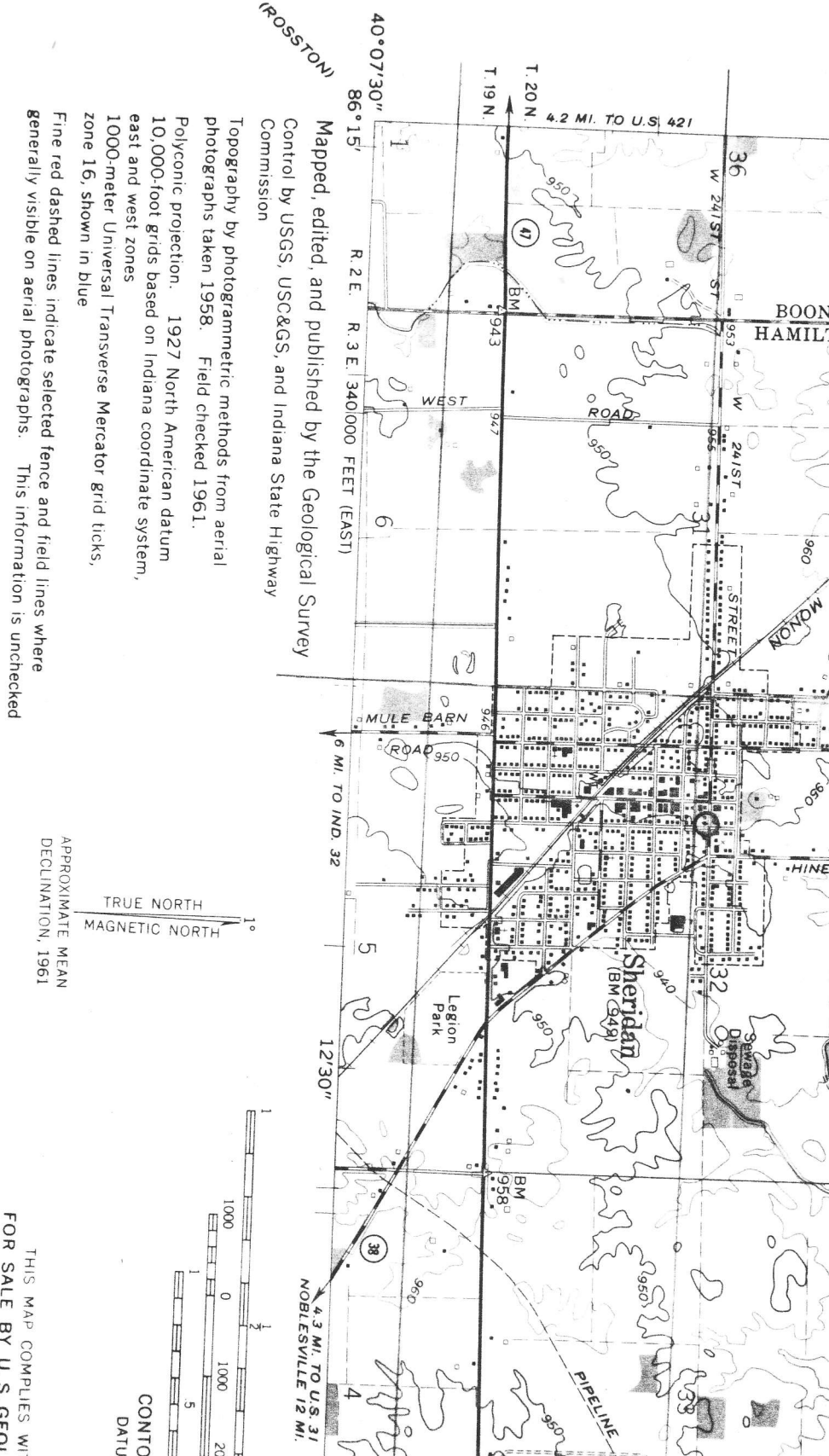

THIS MAP COMPLES WITH  
 FOR SALE BY U.S. GEOL  
 AND INDIANA DEPARTMENT  
 A FOLDER DESCRIBING TOPOGRAPH