

United States Department of the Interior
National Park Service

National Register of Historic Places
Inventory—Nomination Form

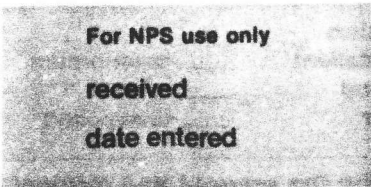

See instructions in *How to Complete National Register Forms*
Type all entries—complete applicable sections

1. Name

historic Westport Covered Bridge

and/or common

2. Location

street & number 1.7 miles east of Westport, Indiana
on Road 1100S N/A not for publication

city, town Westport X vicinity of ~~Congressional district~~

state Indiana code 018 county Decatur code 031

3. Classification

Category	Ownership	Status	Present Use
<input type="checkbox"/> district	<input checked="" type="checkbox"/> public	<input checked="" type="checkbox"/> occupied	<input type="checkbox"/> agriculture
<input checked="" type="checkbox"/> building(s)	<input type="checkbox"/> private	<input type="checkbox"/> unoccupied	<input type="checkbox"/> commercial
<input type="checkbox"/> structure	<input type="checkbox"/> both	<input type="checkbox"/> work in progress	<input type="checkbox"/> educational
<input type="checkbox"/> site	Public Acquisition	Accessible	<input type="checkbox"/> entertainment
<input type="checkbox"/> object	<input type="checkbox"/> in process	<input type="checkbox"/> yes: restricted	<input type="checkbox"/> government
	<input type="checkbox"/> being considered	<input checked="" type="checkbox"/> yes: unrestricted	<input type="checkbox"/> industrial
	N/A	<input type="checkbox"/> no	<input checked="" type="checkbox"/> transportation
			<input type="checkbox"/> museum
			<input type="checkbox"/> park
			<input type="checkbox"/> private residence
			<input type="checkbox"/> religious
			<input type="checkbox"/> scientific
			<input type="checkbox"/> other:

4. Owner of Property

name Decatur County Commissioners

street & number Decatur County Courthouse

city, town Greensburg N/A vicinity of state Indiana

5. Location of Legal Description

courthouse, registry of deeds, etc. County Recorder

street & number Decatur County Courthouse

city, town Greenhouse state Indiana

6. Representation in Existing Surveys

title N/A has this property been determined eligible? ___ yes no

date ___ federal ___ state ___ county ___ local

depository for survey records N/A

city, town state

7. Description

Condition		Check one	Check one
<input type="checkbox"/> excellent	<input type="checkbox"/> deteriorated	<input type="checkbox"/> unaltered	<input checked="" type="checkbox"/> original site
<input type="checkbox"/> good	<input type="checkbox"/> ruins	<input checked="" type="checkbox"/> altered	<input type="checkbox"/> moved date <u>N/A</u>
<input checked="" type="checkbox"/> fair	<input type="checkbox"/> unexposed		

Describe the present and original (if known) physical appearance

The Westport Covered Bridge is located on Road 1100S in a rural setting 1.7 miles east of Westport, Indiana. This single-span bridge was built in 1880 by A. M. Kennedy and Son, using the Burr arch design, one of the era's most common systems of bridge construction. Built to span Sand Creek, the structure is 130' long, 16' wide, and 13' high, and is supported by limestone abutments at either end. Structural members are protected by a gable roof and horizontal shiplap siding. The roof was originally covered with wooden shingles, but this material has since been replaced with metal roofing. The portals at either end of the bridge were originally rounded arches "supported" by pilastered corner boards, but these openings have since been altered (see photo #1). Under the gable is a plain, wide frieze board which carries a series of paired cornice brackets. In 1922, a portion of the siding was removed from either side of the bridge for its entire length, in order to provide increased visibility. The resulting openings are protected by long shed awnings projecting from either side of the structure, covered with asphalt composition shingles. The bridge is structurally sound and was used for vehicular traffic until 1973. It is still open to pedestrian traffic.

8. Significance

Period	Areas of Significance—Check and justify below			
<input type="checkbox"/> prehistoric	<input type="checkbox"/> archeology-prehistoric	<input type="checkbox"/> community planning	<input type="checkbox"/> landscape architecture	<input type="checkbox"/> religion
<input type="checkbox"/> 1400–1499	<input type="checkbox"/> archeology-historic	<input type="checkbox"/> conservation	<input type="checkbox"/> law	<input type="checkbox"/> science
<input type="checkbox"/> 1500–1599	<input type="checkbox"/> agriculture	<input type="checkbox"/> economics	<input type="checkbox"/> literature	<input type="checkbox"/> sculpture
<input type="checkbox"/> 1600–1699	<input type="checkbox"/> architecture	<input type="checkbox"/> education	<input type="checkbox"/> military	<input type="checkbox"/> social/ humanitarian
<input type="checkbox"/> 1700–1799	<input type="checkbox"/> art	<input checked="" type="checkbox"/> engineering	<input type="checkbox"/> music	<input type="checkbox"/> theater
<input checked="" type="checkbox"/> 1800–1899	<input type="checkbox"/> commerce	<input type="checkbox"/> exploration/settlement	<input type="checkbox"/> philosophy	<input checked="" type="checkbox"/> transportation
<input type="checkbox"/> 1900–	<input type="checkbox"/> communications	<input type="checkbox"/> industry	<input type="checkbox"/> politics/government	<input type="checkbox"/> other (specify)
		<input type="checkbox"/> invention		

Specific dates 1880 **Builder/Architect** A. M. Kennedy & Son

Statement of Significance (in one paragraph)

The Westport Covered Bridge is the only covered bridge in Decatur County, Indiana, and is one of the few remaining examples of the work of the A. M. Kennedy family, noted Indiana bridge builders.

Archibald McMichael Kennedy was a carpenter who began constructing small bridges in Wabash County in 1853. His first major bridge project, in Union County, was completed in 1870. His son, Emmett, joined him in his work and the pair built many bridges together until 1884, when Archibald left the firm. From 1884 to 1886, Emmett and his brother, Charles, operated the firm as Kennedy Brothers, but in 1886 Charles left the firm and Emmett worked alone until 1914, when his own sons joined him. In all, the Kennedy family is credited with the construction of 58 covered bridges, of which only 13 survive. The Westport Bridge is apparently the only covered bridge ever constructed in Decatur County, and was recently repaired by the Decatur County Historical Society, Inc.

9. Major Bibliographical References

Decatur County Commissioners Record Book #11, 1878-1881
See additional bibliography on continuation sheet

10. Geographical Data

Acreeage of nominated property Less than one acre

Quadrangle name Westport, Indiana

Quadrangle scale 1:24000

UMT References

A

1	6	6	2	5	5	7	0	4	3	3	6	0	9	0
Zone		Easting				Northing								

B

Zone		Easting				Northing								

C

--	--	--	--	--	--	--	--	--	--	--	--	--	--	--

D

--	--	--	--	--	--	--	--	--	--	--	--	--	--	--

E

--	--	--	--	--	--	--	--	--	--	--	--	--	--	--

F

--	--	--	--	--	--	--	--	--	--	--	--	--	--	--

G

--	--	--	--	--	--	--	--	--	--	--	--	--	--	--

H

--	--	--	--	--	--	--	--	--	--	--	--	--	--	--

Verbal boundary description and justification

The boundary includes the bridge, its abutments, and 10' of the roadway at either end.

List all states and counties for properties overlapping state or county boundaries

state	code	county	code
N/A			

state	code	county	code
-------	------	--------	------

11. Form Prepared By

name/title Van P. Batterton

organization Decatur County Historical Society date May 21, 1979

street & number 525 N. Broadway telephone _____

city or town Greensburg state Indiana 47240

12. State Historic Preservation Officer Certification

The evaluated significance of this property within the state is:

national state local

As the designated State Historic Preservation Officer for the National Historic Preservation Act of 1966 (Public Law 89-665), I hereby nominate this property for inclusion in the National Register and certify that it has been evaluated according to the criteria and procedures set forth by the National Park Service.

State Historic Preservation Officer signature

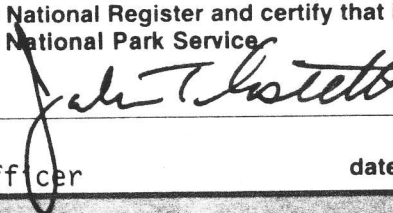

title Indiana State Historic Preservation Officer date 5-13-82

For NPS use only

I hereby certify that this property is included in the National Register

date

Keeper of the National Register

Attest:

date

Chief of Registration

BIBLIOGRAPHY

- Gould, George E. The Covered Bridges of Indiana, (Indianapolis, Covered Bridge Society, Inc. 1973).
- Gould, George E., Indiana Covered Bridges Thru the Years, (Indianapolis, Indiana Covered Bridge Society, Inc. 1977)
- Yule, R. B., The Covered Bridge in Indiana, (Indianapolis, Indiana State Highway Commission, 1971)

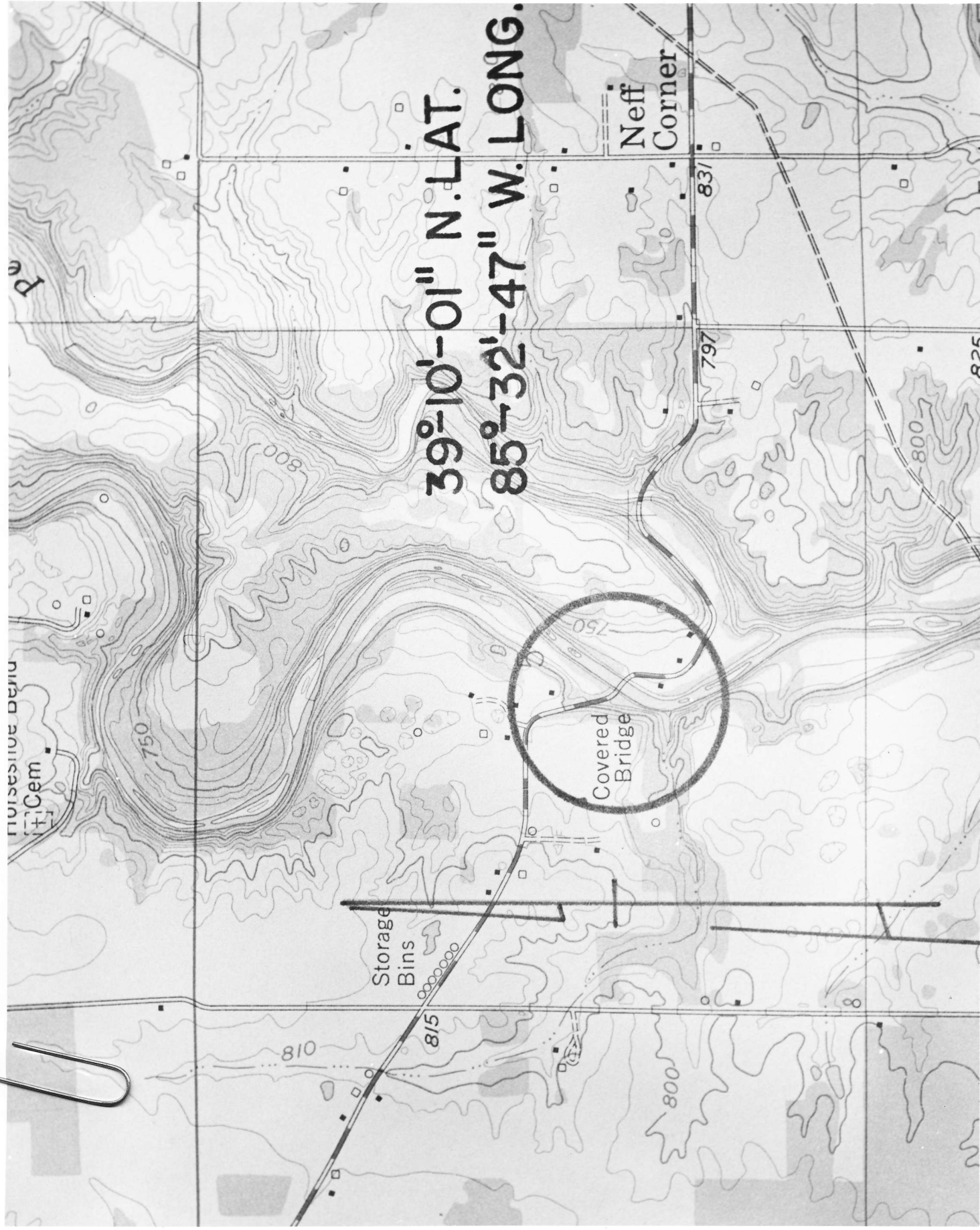

39°-10'-01" N. LAT.
85°-32'-47" W. LONG.

Aggressive Bend
Cem

Storage
Bins

Covered
Bridge

Neff
Corner

