

(OSSIAN)
3965 1 NW

Mapped, edited, and published by the Geological Survey
Revised in cooperation with State of Indiana
Department of Conservation

Control by USGS, NOS/NOAA, and Indiana Flood Control and
Water Resources Commission

Planimetry by photogrammetric methods from aerial photographs
taken 1951. Topography by planetable surveys 1956. Revised 1963

Polyconic projection. 10,000-foot grid ticks based on Indiana coordinate
system, east zone. 1000-meter Universal Transverse Mercator grid
ticks, zone 16, shown in blue. 1927 North American Datum 1927
To place on the predicted North American Datum 1983 move the
projection lines 1 meter south and 3 meters west as
shown by dashed corner ticks

Fine red dashed lines indicate selected fence and field lines where
generally visible on aerial photographs. This information is unchecked
Red tint indicates areas in which only landmark buildings are shown

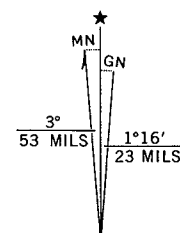

UTM GRID AND 1981 MAGNETIC NORTH
DECLINATION AT CENTER OF SHEET

AND



© 2008 Tele Atlas
© 2008 Europa Technologies
Image/IndanMap Framework Data

© 2007
Google

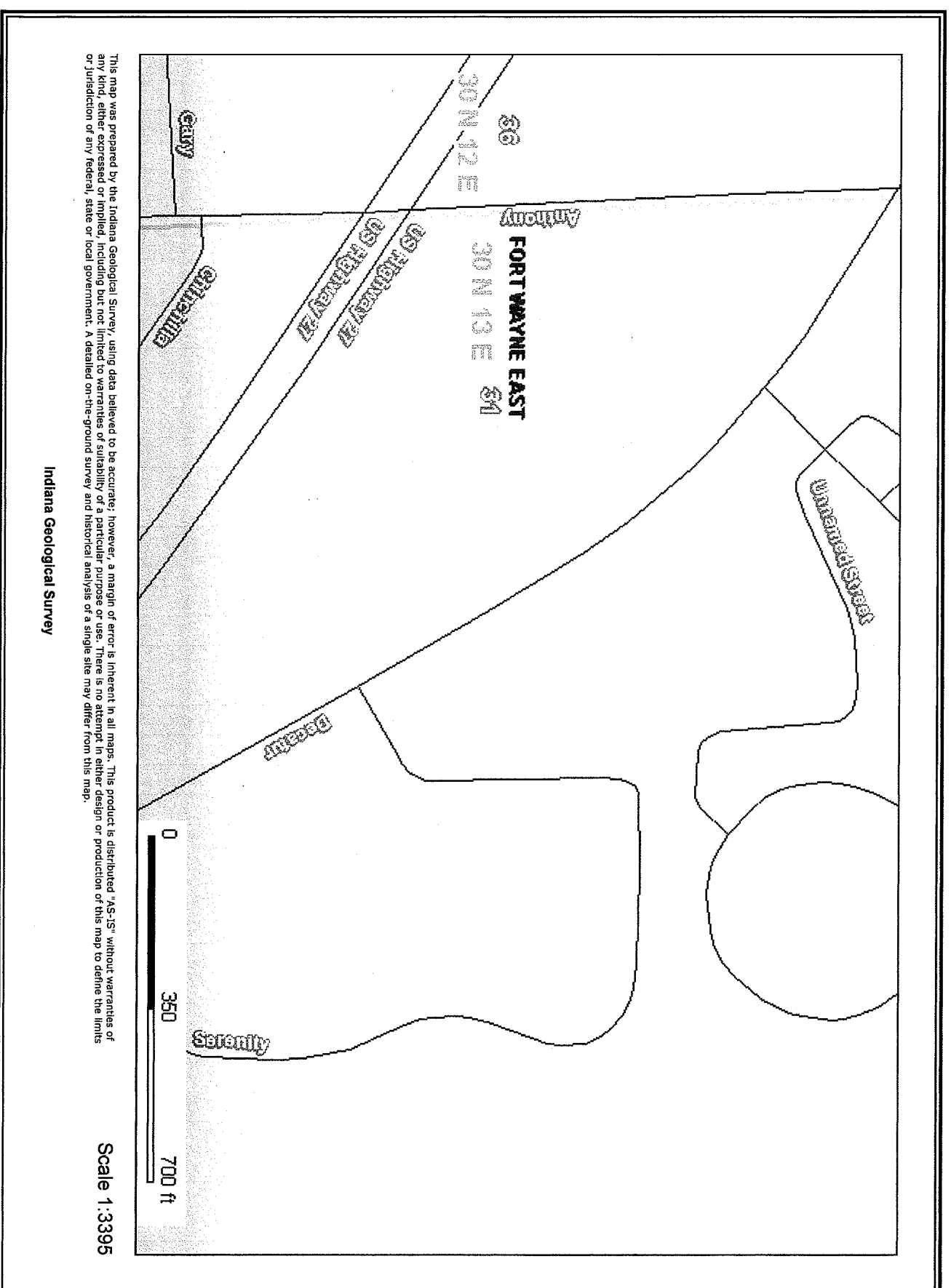

This map was prepared by the Indiana Geological Survey, using data believed to be accurate; however, a margin of error is inherent in all maps. This product is distributed "AS-IS" without warranties of any kind, either expressed or implied, including but not limited to warranties of suitability of a particular purpose or use. There is no attempt in either design or production of this map to define the limits or jurisdiction of any federal, state or local government. A detailed on-the-ground survey and historical analysis of a single site may differ from this map.

Indiana Geological Survey

Scale 1:3395

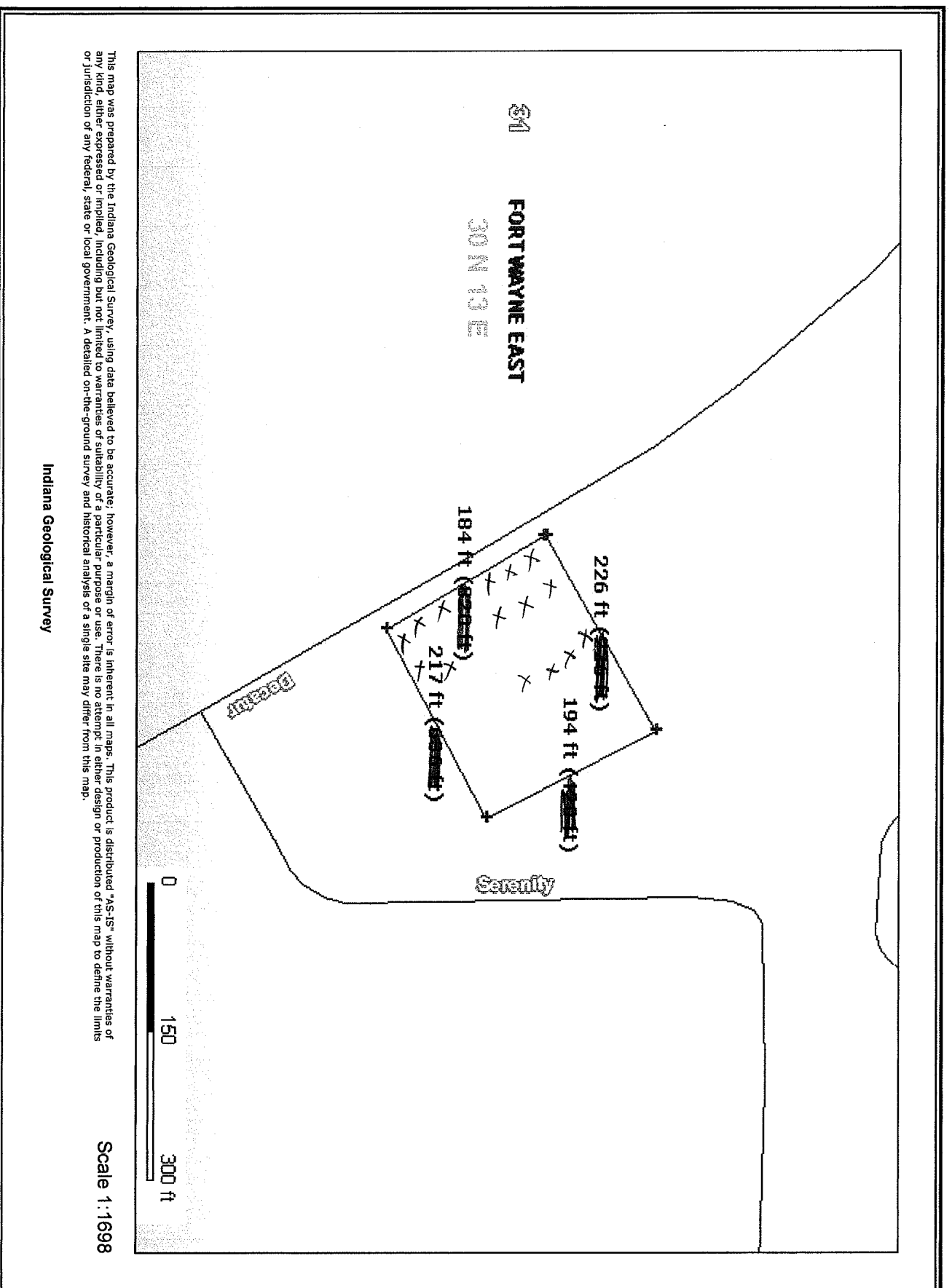

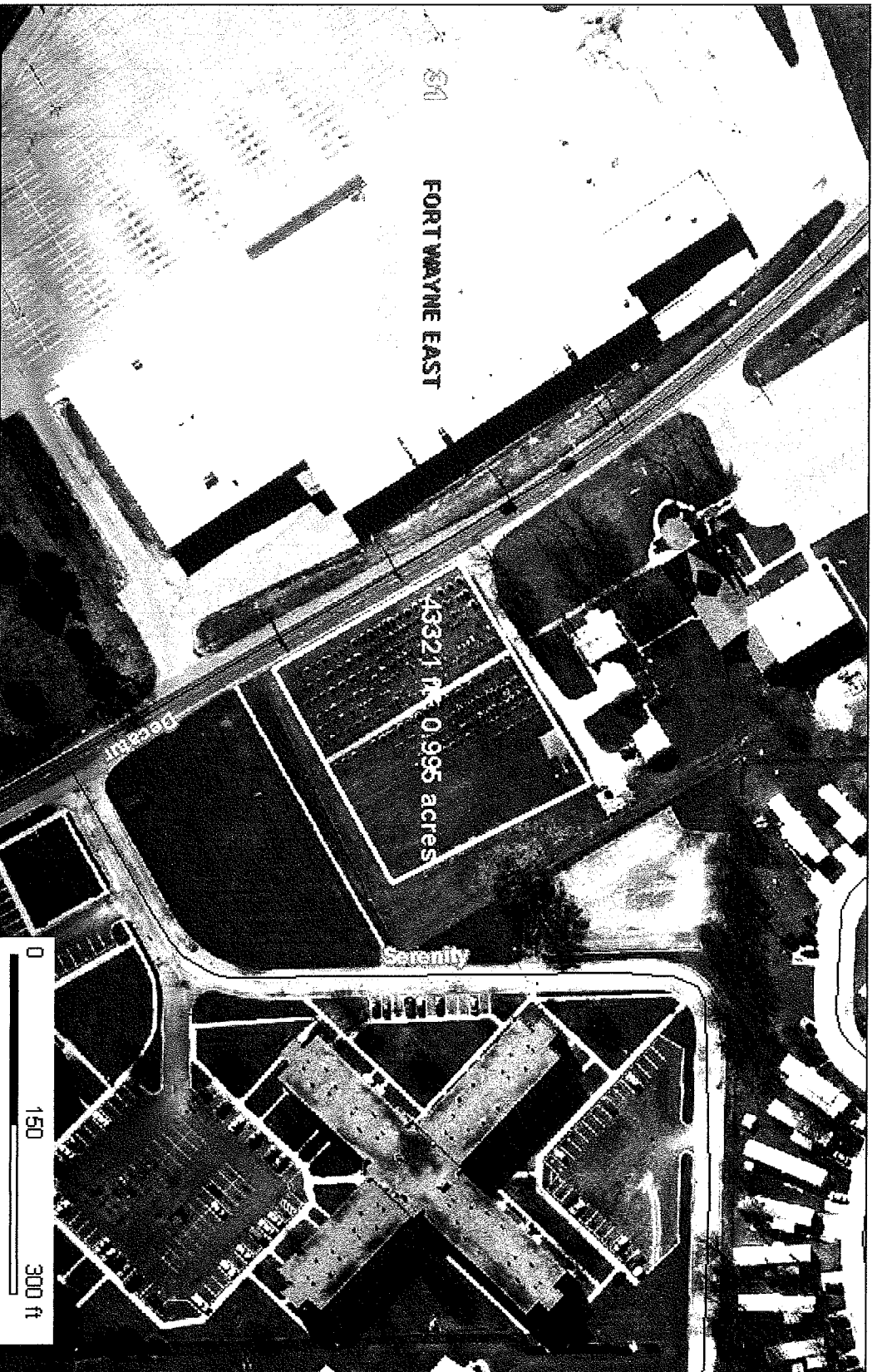

This map was prepared by the Indiana Geological Survey, using data believed to be accurate; however, a margin of error is inherent in all maps. This product is distributed "AS-IS" without warranties of any kind, either expressed or implied, including but not limited to warranties of suitability of a particular purpose or use. There is no attempt, in either design or production of this map to define the limits or jurisdiction of any federal, state or local government. A detailed on-the-ground survey and historical analysis of a single site may differ from this map.

Scale 1:1698

Indiana Geological Survey